



ZCWD SBAC SSTP SUPPLEMENTAL BID BULLETIN NO. 2022-003

Subject: PR No. 22-0113 – Design, Build, Testing & Commissioning of Proposed 4,000 CMD Sewage & Septage Treatment Plant

This **ZCWD SBAC SSTP SUPPLEMENTAL BID BULLETIN** is issued to clarify, modify or amend items in the issued Bidding Documents for the above-subject procurement in view of the **Pre-Bid Conference** last **July 21, 2022**, at the Board Room, 2nd Floor, ZCWD Bldg., Pilar Street, Zamboanga City and via Zoom Video Conferencing.

In response to the inquiries of **JZ Aguiba Construction and Technical Services, Inc.**, dated **August 8, 2022**, thru email, please see the below answers:

Inquiries/Questions	Answer
1. Conceptual Design. Is it really required to have the primary settling tank? The performance specifications (5.6.2 and 5.6.3 pages 107 & 108) says it may not be included.	Similar query answered in ZCWD SBAC SSTP SUPPLEMENTAL BID BULLETIN NO. 2022-002 item No. 2.
2. We will need a uniform basis for the design. Please provide INFLUENT parameters (BOD, COD, TSS, pH, Oil & Grease, TKN, TN, Ammonia, Nitrate, Phosphate, Alkalinity, Surfactants, others).	Similar query answered in ZCWD SBAC SSTP SUPPLEMENTAL BID BULLETIN NO. 2022-002 item No. 6.
3. Who will shoulder the POWER CONSUMPTION during the testing, commissioning and process proving, respectively?	Similar query answered in ZCWD SBAC SSTP SUPPLEMENTAL BID BULLETIN NO. 2022-002 item No. 8.
4. Who will shoulder the CHEMICALS during the testing, commissioning and process proving, respectively?	Similar query answered in ZCWD SBAC SSTP SUPPLEMENTAL BID BULLETIN NO. 2022-002 item No. 8.
5. Who will shoulder the 3rd Party Laboratory Fees during the testing, commissioning and process proving, respectively?	Similar query answered in ZCWD SBAC SSTP SUPPLEMENTAL BID BULLETIN NO. 2022-002 item No. 8.

<p>6. Please provide the format of BOQ, it was not included in the current set of bid documents that we downloaded from ZCWD website.</p>	<p>Similar request answered in ZCWD SBAC SSTP SUPPLEMENTAL BID BULLETIN NO. 2022-002 item No. 11 and the BOQ attached thereto.</p>
<p>7. Please provide details of the existing pumps and controller at the existing lift station (West Pumping Station) to the proposed STP. If needed replacement, is it subject to variation order?</p>	<p>In addition to similar request answered in ZCWD SBAC SSTP SUPPLEMENTAL BID BULLETIN NO. 2022-002 item No. 14, please refer to below.</p> <p>The West Pumping Station (WPS) has 1 unit 7.5Hp, 220 Volts, 19 Amperes, 3 Phase at 8,6675 rpm, Multi stages Pump with 550gpm capacity that is currently being used to pump the wastewater from WPS to its outfall. However, per Performance Specifications, the contractor is mandated to install a new motor pump with a pipeline to transfer the six (6) MLD wastewater from WPS going to the proposed SSTP and this shall form part of the bid offer, hence not subject to variation orders.</p>
<p>8. On item 4.1.5.6. page 48. Which equipment are required to be tested at the manufacturer, where the ZCWD representatives will be present? As discussed during the prebid, this provision is not applicable and must be deleted. Same is requested for item 4.4.3.11.2.1 on page 67.</p>	<p>Item 4.1.5.6 is DELETED.</p> <p>Item 4.4.3.11.2.1 is MODIFIED to read:</p> <p><i>“4.4.3.11.2.1. All equipment supplied under this Contract shall be tested for quality of workmanship at the manufacturer’s premises. On delivery to site, the ZCWD Engineer and or Inspection Team shall inspect any and all plant and equipment and any plant and equipment not complying with the specification shall be immediately rejected by ZCWD. The replacement costs, freight costs and other incidental expenses of the same shall be the on the account of the Contractor;”</i></p> <p>All equipment installed or in-placed shall only be tested at the project site with the presence of the ZCWD representatives. Manufacturer testing reports shall be submitted to the ZCWD for reference.</p>

<p>9. The MRF will be relocated to the open market. Kindly advise who will be responsible for the talks and negotiations for the moving out of the existing vendors at the proposed site.</p>	<p>Pursuant to the Memorandum of Agreement by and between the City of Zamboanga and ZCWD executed on February 18, 2021, the former is to provide any other technical assistance needed and coordinate with the ZCWD before, during project implementation, testing, and until commissioning of the project and carry out all other appropriate administrative arrangements as may be necessary to facilitate the implementation of the project.</p> <p>ZCWD, together with contractor, will be assisted by the LGU to move the existing vendors at the site.</p>
<p>10. Advise us to where we will put the debris collected from the demolition of the existing MRF.</p>	<p>Some materials from the demolition of the MRF can be reused considering the viability and structural integrity thereof. Those which are for disposal will be disposed and sorted at the Cabatangan (Lupong Road) property of ZCWD and the hauling and transportation of which shall be on the account of the contractor.</p>
<p>11. Are we going to apply for a new service entrance for the new MRF?</p>	<p>The MRF is a property of the LGU, as well as the property upon which the new MRF will be constructed. As such, the LGU will be designating its new service entrance at the public market.</p>
<p>12. Please provide minimum pipe diameter for the proposed 400m pipeline from West Pumping Station (WPS) to the SSTP.</p>	<p>The diameter of the proposed pipeline from West Pumping Station to the proposed SSTP as well as the new motor pump (to upgrade the existing motor pump) shall be designed to carry the 6,000 cu.m./day wastewater from West Pumping Station going to the proposed SSTP.</p>
<p>13. Please provide concept drawing of the proposed path of the 400m pipeline from WPS to the SSTP.</p>	<p>Please refer to page 131 of the Performance Specifications. Pipeline shall be laid only in a right of way.</p>
<p>14. Is it allowed that the 400m pipeline above will be installed along the riverbank?</p>	<p>The bidder designer's discretion based on sound engineering will be allowed subject to approval and/or issuance of permits by concerned government agencies. The pipeline diameter and the new motor pump (to upgrade the existing motor pump) will be designed to have a carrying capacity of</p>

	6,000 cu.m./day of wastewater.
15. The project site is located near a mosque, we also respect the Muslim community to not make any disturbance at their worship time. What will be the allowable working hours during their time of worship (daily, weekly)?	This can be arranged during the project Implementation in coordination with the City of Zamboanga.
16. The construction period will also hit the Ramadan period. Kindly advise the allowable working hours and other construction limitations (if any) during this period.	This can be arranged during the project Implementation in coordination with the City of Zamboanga.
17. Please provide a copy of as-built plans of the WPS and MRF	<p>As the PSs were constructed in the early 30's, as the as-built plan was preserved by framing them. This is currently hanged at East Pumping Stations and there are no electronic copies thereof. Attached here are the photographs of the as-built plans of the pumping stations.</p> <p>As to the MRF, the ZCWD does not have possession of its as-built plans. For reference, a layout of the MRF is annexed in the Revised Performance Specifications.</p>
18. Schedule. Please clarify if the 610 calendar days includes the 1 year process proving period.	The 1 year process proving period is <u>excluded</u> in the 610 calendar days.
19. Is the permitting stage included in the 610 calendar days?	All necessary permits such as excavation, building permit, fencing permit, and electrical permit, among others shall be included in the 610 calendar days project duration.
20. Please confirm this statement in pages 26 and 29, as this will have a significant effect on the bid price: "Materials and equipment delivered on the site but not completely put in place shall NOT be included for payment"	Materials and equipment as part of the item of work which have been delivered on site but not yet installed or in-placed shall not be paid; unless the said materials and equipment have been used, utilized or consumed to complete an item of work. The payment shall be based on the quantity accomplished of the item of work as stipulated in the BOQ.

	Refer to Section IV. General Conditions of Contract 14. Progress Payments of the PBD for guidance.
21. For the available area of 2,196 sqm, what is the minimum setback of the structures from the property line? Can we construct structures along the property or fence line, especially administration and other buildings?	All setback requirements shall follow the provision of the National Building Code of the Philippines.
22. On item 3.3.1.13. page 12 of Performance specifications: Please provide the stated “Annex 1” – “reference design for the force main connected from the West Pumping Station...”	Please refer to page 131 of the Performance Specifications.
23. On item 3.3.1.26. page 16: Please provide the required water quality stated in “standards for reuse”	The guidelines available are for agricultural reuse. However, for the purpose intended by ZCWD, kindly refer to 6.1.4 page 118 for the parameters required. (BOD5 should be 30 mg/l, COD should be 60 mg/l, Fecal Coliform of 200 MPNB/100 ml and Total Coliforms shall be 3,000 MPN/100 ml or better.)
24. On item 3.3.2.2. page 16: what is the minimum depth that will require sheet piling? e.g. will 1.2m excavation depth require sheet piling?	Kindly refer to the Geotechnical Investigation Report in the Revised Performance Specification, as integral part of the bidding documents for the soil condition at the site. The depth of sheet piling during excavation shall be at the point that it will protect the adjacent structures/building as well as those who are working in the project.
25. On item 3.3.3.5. page 24. We believe this provision is not applicable to this project. We request to delete this provision.	For reference, section 3.3.3.5 states “All valves shall withstand a hydrostatic test pressure of at least 150 psi and shall be of solenoid types.” Should there be a need to propose a valve in this project, the said valve shall have a pressure rating of at least 16 bars supported by the brochure for it to withstand a hydrostatic pressure of 150psi. and it shall be of either <u>solenoid type</u> , <u>motorized or pneumatic valve</u> . The valve doesn't need to

	undergo 150psi hydrostatic pressure at the SSTP.
26. On item 3.3.3.7. page 24. We believe this provision is not applicable to this project. We request to delete this provision. Actual operating pressure will not even reach 2 bars, plus subjecting the valves to 1.5 times the pressure rating, or equivalent to 24 bars, could damage the valves. It is recommended that valve rating to be 10 bars minimum, subjected to 1.5 times the working pressure (as stated in Item 4.4.3.11.4.1.2 page 68)	<p>For reference, section 3.3.3.7 All valves shall be designed for a pressure rating of 16 bars and a test pressure of 1.5 times the pressure rating.</p> <p>Should there be a need to propose a valve in this project, the said valve shall have a pressure rating of at least 16 bars supported by the brochure. The valve doesn't need to undergo hydrostatic pressure at the SSTP.</p>
27. On item 3.3.3.8. page 24. Mobile type generator is not applicable in the specification, as the genset will be installed in 33sqm housing. We request to remove this provision.	<p>The intention of the provision is also provided therein in the first sentence. The objective is to ensure that all electro-mechanical installations are climate resilient and will be safe in case of flooding. The purpose of the genset being preferred to be movable from place to place is to be able to facilitate its transfer when the need arises. If the genset housing will be at an elevation that will ensure that this will not be affected by flooding, you may so offer and this will be considered.</p> <p>A minimum 33-sq.m. genset room shall be constructed to house the mobile generator (trailer type).</p>
28. Please provide list of third party contractors or service providers for the disposal of "scum, oil and grease" in Zamboanga.	Currently, there are no service providers in Zamboanga City for the collection and disposal for scum, oil and grease. The nearest service provider is located in Cagayan de Oro City.
29. Please provide list of items/equipment to be transferred from the existing to the new MRF facility.	The items/equipment to be transferred from the existing to the new MRF facility are those which are currently found therein. This can be viewed upon ocular inspection of the site. For your reference, a lay-out of the MRF will be provided.
30. On item 4.1.5.8 page 48. This provision may not be applicable to this project. We	Should this provision be applicable, before final acceptance, the hoist, trolleys and monorails shall be tested and given the rated

request to delete this.	load test in accordance with ASME B30.11 standard.
31. On item 4.2.1 page 48. Please provide the copy of the ECC, as the contractor“shall also be bound to comply with the conditions enumerated in the ECC.”	A copy of the ECC shall be provided to the winning bidder.
32. Please clarify the drawing print size:A1 or 24” x 36”?	The engineering detailed plan for the proposed SSTP shall be printed in paper size 24” x 36” or A1.
33. On item 4.4.3.1.4 page 60. Is it really required for the submersible pumps impeller material to be “stainless steel / bronze”? this would be special order from the equipment manufacturer.	Yes, the submersible pump impeller material to be used in wastewater shall be stainless or bronze to satisfy the requirements for corrosion, erosion and/or cavitation.
34. On item 4.4.3.3.1 page 61. Can we lower the requirement to PN10 or equivalent? The actual operating pressure is less than 2 bars.	The ZCWD requires PN16 for all pipework associated with the pumping unit and associated fittings regardless of the actual operation pressure.
35. item 4.4.3.4.7 page 63. This is not applicable. We request to delete this provision.	Should there be a need to propose a valve in this project, the valve shall be of either type: solenoid type, motorized or pneumatic valve.
36. On item 4.4.3.11.2 page 67. this may not be applicable for wastewater treatment. We request to delete the provision.	<p>4.4.3.11.2. Testing of Pump before Delivery is RETAINED and Item 4.4.3.11.2.1 is MODIFIED to read:</p> <p><i>“4.4.3.11.2.1. All equipment supplied under this Contract shall be tested for quality of workmanship at the manufacturer’s premises. On delivery to site, the ZCWD Engineer and or Inspection Team shall inspect any and all plant and equipment and any plant and equipment not complying with the specification shall be immediately rejected by ZCWD. The replacement costs, freight costs and other incidental expenses of the same shall be the on the account of the Contractor;”</i></p>

	All equipment installed or in-placed shall only be tested at the project site with the presence of the ZCWD representatives. Manufacturer testing reports shall be submitted to the ZCWD for reference.
37. Item 4.5.1.2 page 70. Please provide list of the said equipment, as most equipment will be sourced abroad, and the cost of spares would be equivalent to the cost of equipment itself.	All equipment directly involved in the treatment process shall have redundancy. The items referred herein are those which the bidder contractor deems to be “of specialized nature.” It is the bidder/contractor who will therefore determine whether certain equipments are of “specialized nature” or are not easily available in the country.
38. Item 4.5.2.4.1 page 72. Please confirm that you require “type-tested design” for the main switchboard.	Yes type-tested design for main switchboard is required
39. Item 4.5.3.5.1 page 75. Please clarify what you mean with the shipping not later than 4 months. What is the reference point of the said 4 months (i.e. from NTP, from NOA, etc)?	4.5.3.5.1. is MODIFIED to read: “The MCC shall be delivered in sections provided that it will be installed prior to and in time for testing and commissioning. Each section shall be suitably braced and have lifting points so that during a crane lift no distortion will take place. Assembly instruction shall accompany the equipment.”
40. Item 5.1.4 page 95 states that there will be 90 days commissioning period. It will be followed by the process proving period. Is there an approval period (or equivalent) between the 90 days commissioning period and the 1 year process proving period? If there is, please give approximate (minimum and/or maximum) number of days.	Upon compliance to the conditions for commissioning, ZCWD shall issue a Certificate of Commissioning after which the contractor will proceed to the 1 year process proving.
41. Item 6.1.14 page 119. Due to the available area and lot shape, there would be instances where the tank length-to-width ratio will not be within the range provided.	As provided therein, deviation shall be allowed.

Is it acceptable?	
42. Annexes, page 123. Please provide the “Physical and Chemical Analysis of Sewage” and “Survey and Mapping”	<i>Survey and Mapping</i> are provided in the Performance Specifications through Annex as reference only. Per Section 7 of Annex “G” of the IRR of RA 9184, the procuring entity does not guarantee that these data are fully correct, up to date, and applicable to the project at hand. The contractor is responsible for the accuracy and applicability of all data, including the above, that it will use in its design and build proposal and services.

These clarifications shall form an integral part of the Bidding Documents. All items, conditions and instruction to bidders specified in the Bidding Documents inconsistent with this Supplemental Bid Bulletin are hereby superseded and modified accordingly.

For guidance and information of all concerned.



MICHAEL ANGELO M. CARBON

Chairperson

Bids and Awards Committee

Posting date: August 24, 2022

Posted in the Phil-GEPS, ZCWD Website & Bid Bulletin

Important Notes:

It is the responsibility of the bidder to take steps to carefully examine all of the Bidding Documents. The Procuring Entity shall not assume any responsibility regarding erroneous interpretations or conclusions by the prospective or eligible bidder out of the data furnished by the Procuring Entity.

A prospective eligible bidder must be responsible for having: 1. Taken steps to carefully examine all of the bidding documents; 2. Acknowledged all conditions, local or otherwise, affecting the implementation of the contract; 3. Made an estimate of the facilities available and needed for the contract to be bid, if any; and 4. Complied with his responsibility that it shall be the responsibility of all those who have properly secured the bidding documents to inquire and secure supplemental/bid bulletins that may be issued by the BAC (Government Procurement Manual Volume 3).

Failure to observe any of the above responsibilities shall be at the risk of the prospective bidder concerned. The Procuring Entity shall not be responsible for any erroneous interpretation or conclusions by the prospective or eligible bidders of the data it furnished (Government Procurement Manual Volume 3).



PHOTOGRAPHS OF AS-BUILT PLAN OF THE SEWAGE PUMPING STATIONS

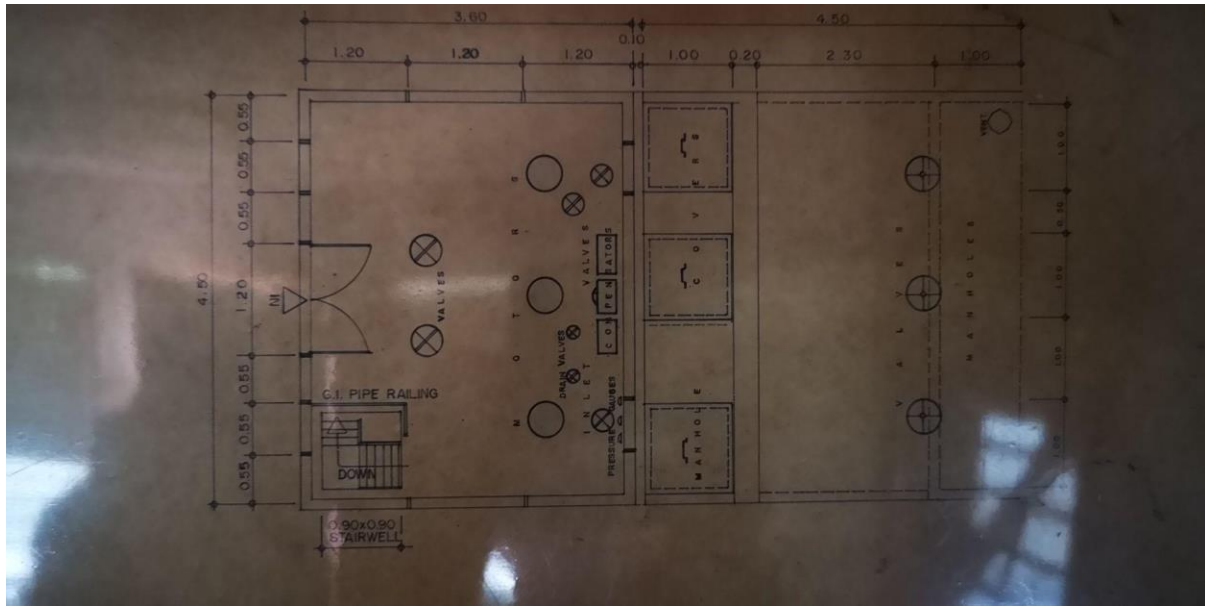

Floor Plan of Pump Building

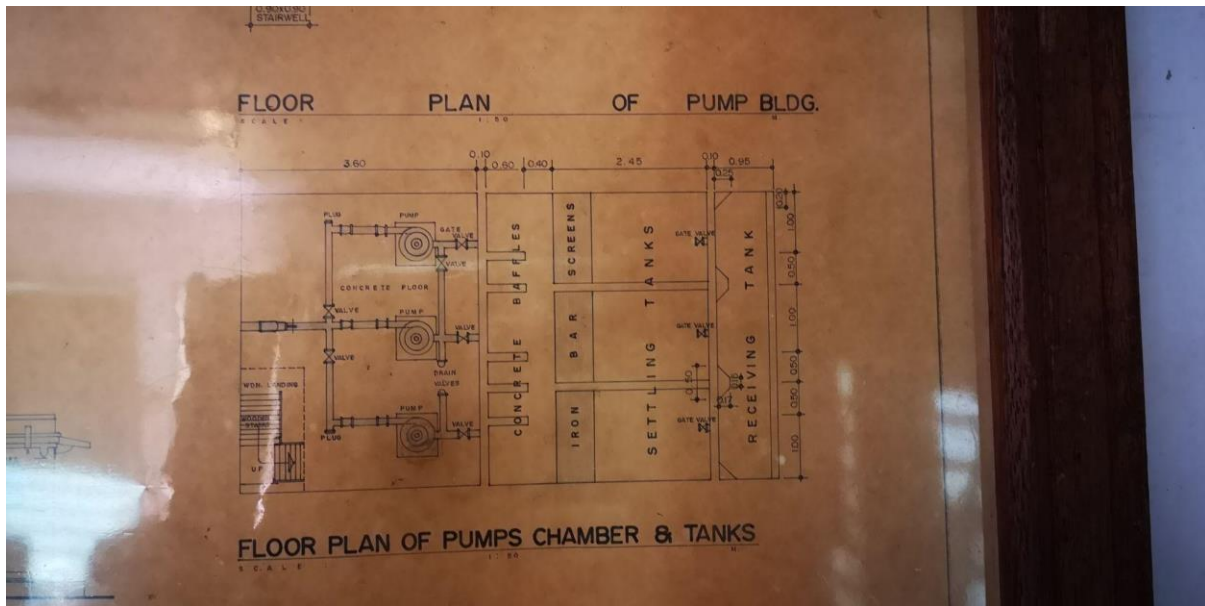

Floor Plan of Pumps Chamber & Tanks



Republic of the Philippines
ZAMBOANGA CITY WATER DISTRICT
Pilar Street, Zamboanga City

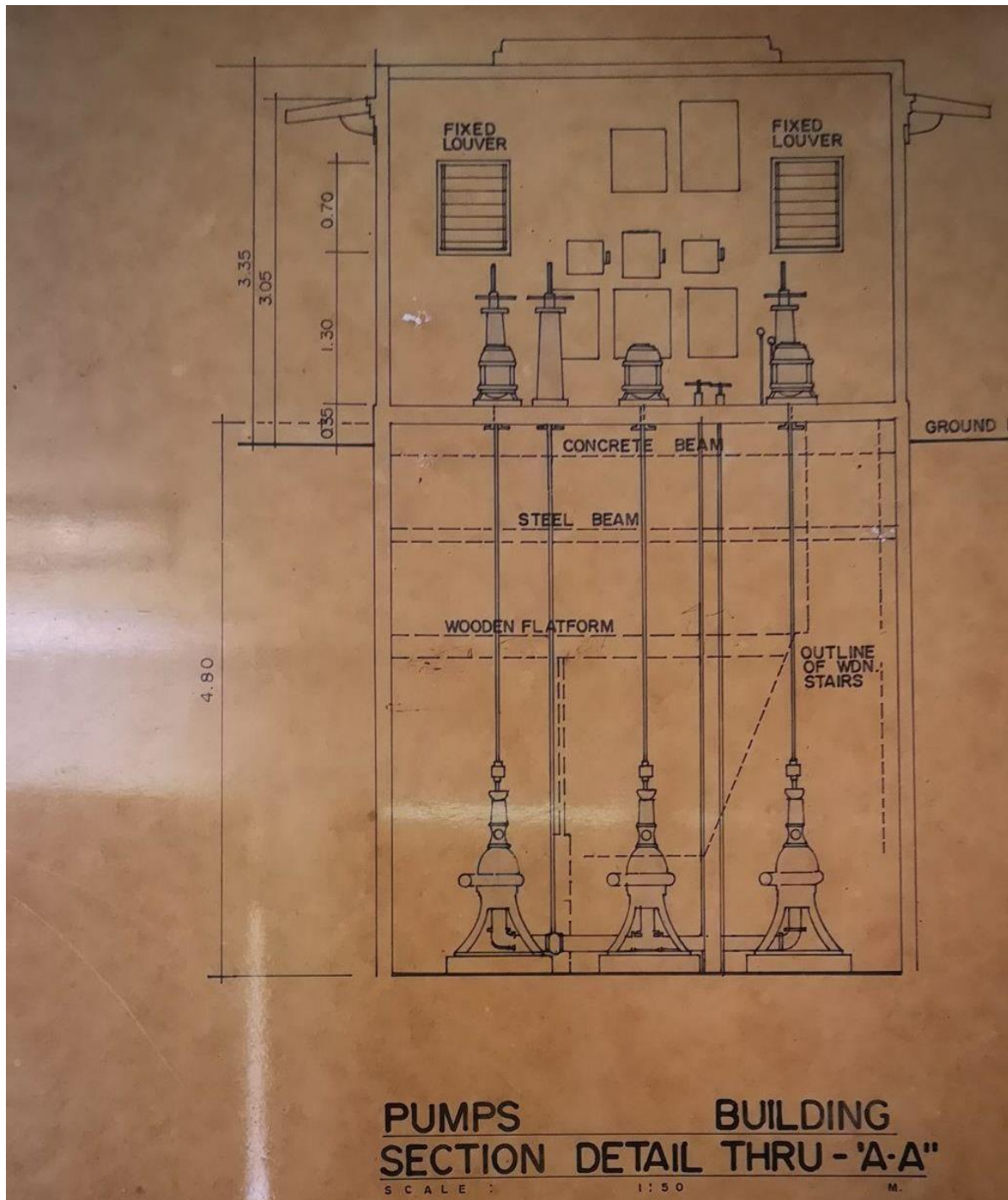

Pumps Building



Republic of the Philippines
ZAMBOANGA CITY WATER DISTRICT
Pilar Street, Zamboanga City

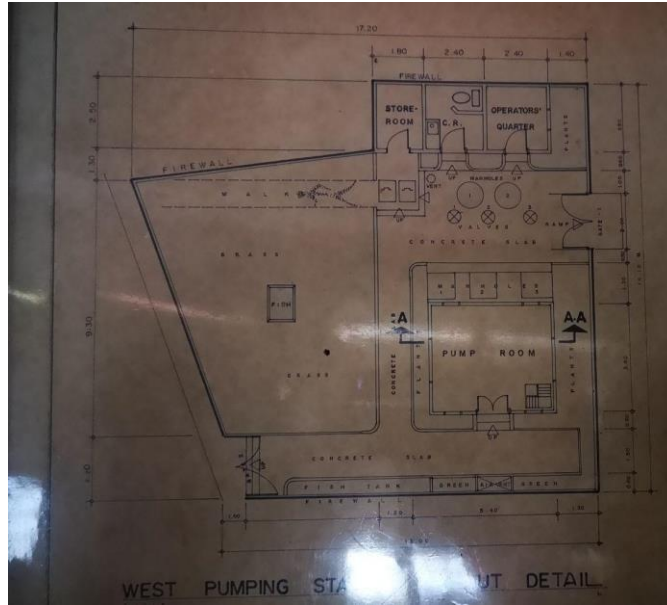

West Pumping Station Layout Detail