

LEGEND:

- 1 - PROP. 254.23 LN. M. 150mmØ PVC PIPELINE, CLASS 150
- 2 - PROP. 150mmØ C.I. SLEEVE TYPE FLEXIBLE COUPLING, (C.I.-PVC)
- 3 - PROP. 150mmØ C.I. ADAPTOR, F/P
- 4 - PROP. 150mmØ C.I. BODY GATE VALVE, F/F
- 5 - PROP. 150mmØ x 150mmØ C.I. TEE, M/F
- 6 - EXISTING 100mmØ PVC PIPELINE
- 7 - PROP. 150mmØ PVC SHORT PIPE, CLASS 150
- 8 - PROP. 150mmØ x 100mmØ PVC REDUCER, CLASS 150
- 9 - PROP. 100mmØ C.I. SLEEVE TYPE FLEXIBLE COUPLING, (PVC)
- 10 - EXISTING 100mmØ CLCI PIPELINE (FOR DECOMMISSION)

INTER-CONNECTION DETAIL OF CORCUERRA ST.

SCALE:

NTS

(CORCUERRA ST.)
SITE DEVELOPMENT PLAN

SCALE: 1:8m

CORCUERRA ST.

	PREPARED BY: BUNNY L. DAMPIGS SENIOR ENGINEER A/C E DESIGN DIVISION	 LEONARDI S. ALCALA, CE ENGINEER I/CE DIV. CHIEF PLANNING, DESIGNING AND PROGRAMMING DIVISION, CE	 MICHAEL A. FRANCISCO ENGINEER II, CE DIV. CHIEF PLANNING, DESIGNING AND PROGRAMMING DIVISION, CE	 MICHAEL C. PALANCA, CE ENGINEER II DIV. ASSISTANT ENGINEER, CE	 CHRISTOPHER O. NAVARRO DIV. ASSISTANT ENGINEER, CE	PROJECT: MAINLINE REPLACEMENT PROGRAM (LGU FUNDED) PHASE 2	SHEET NO: 06	
	 VERLIN ANN B. LACASTESANTOS-LORIA SENIOR ENGINEER I/E DESIGN DIVISION	 REX D. SALE JR., CE SENIOR ENGINEER I/A DESIGN DIVISION, ZCWD	 EDITO M. BAUTISTA JR., CE OFFICER-IN-CHARGE DESIGN DIVISION, ZCWD	 MARLI P. ACOSTA-DE FIESTA DATA ENGINEER & CONSTRUCTION DEPARTMENT P.C. TECHNICAL SERVICES GROUP, ZCWD	 REYNALDO R. CABILIN ACTING GENERAL MANAGER, ZCWD	SHEET CONTENT: AS INDICATED		

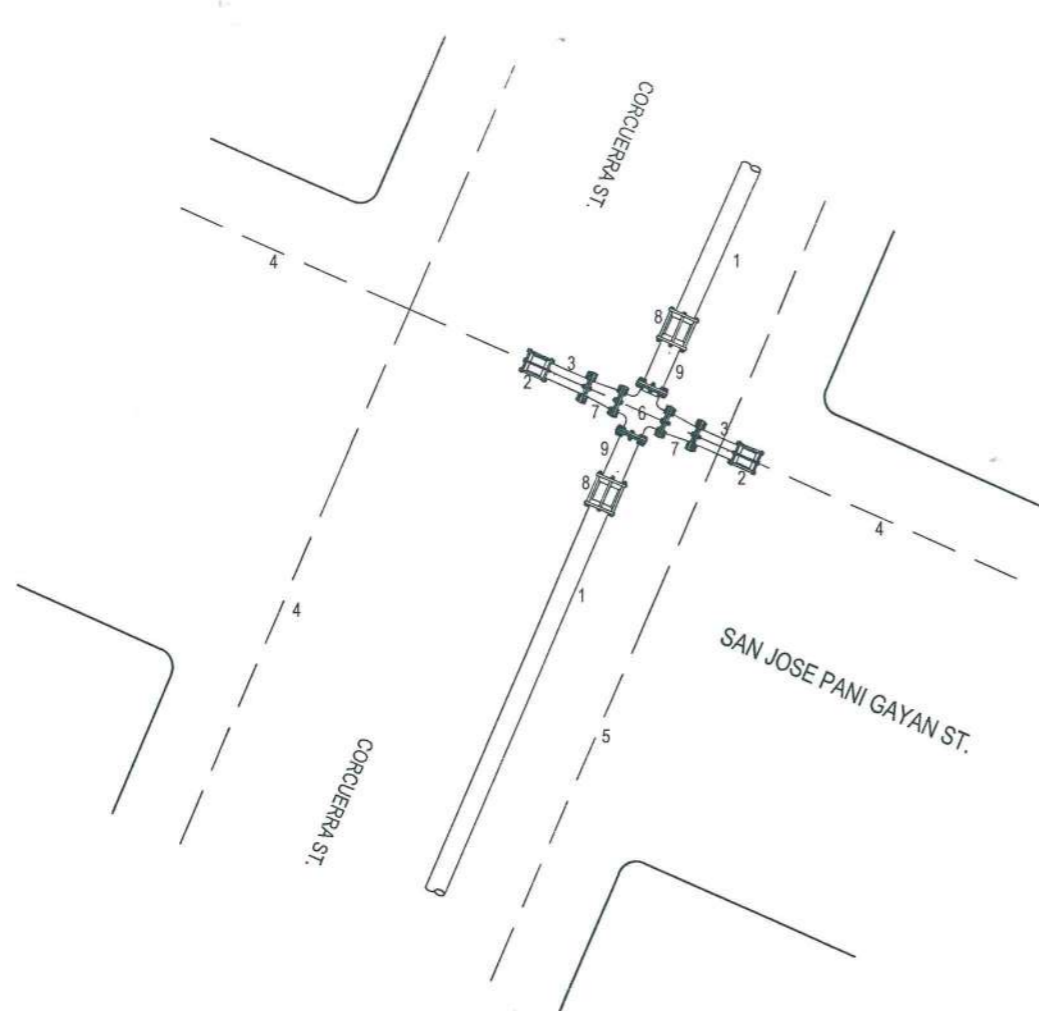

D2

LEGEND:

- 1 - PROP. 254.23 LN. M. 150mmØ PVC PIPELINE, CLASS 150
- 2 - PROP. 100mmØ C.I. SLEEVE TYPE FLEXIBLE COUPLING, (C.I.-PVC)
- 3 - PROP. 100mmØ C.I. ADAPTOR, F/P
- 4 - EXISTING 100mmØ PVC PIPELINE
- 5 - EXISTING 100mmØ CLCI PIPELINE (FOR DECOMMISSION)
- 6 - PROP. 150mmØ x 150mmØ C.I. CROSS TEE, F/F
- 7 - PROP. 150mmØ x 100mmØ C.I. REDUCER, F/F
- 8 - PROP. 150mmØ C.I. SLEEVE TYPE FLEXIBLE COUPLING, (C.I.-PVC)
- 9 - PROP. 150mmØ C.I. ADAPTOR, F/P

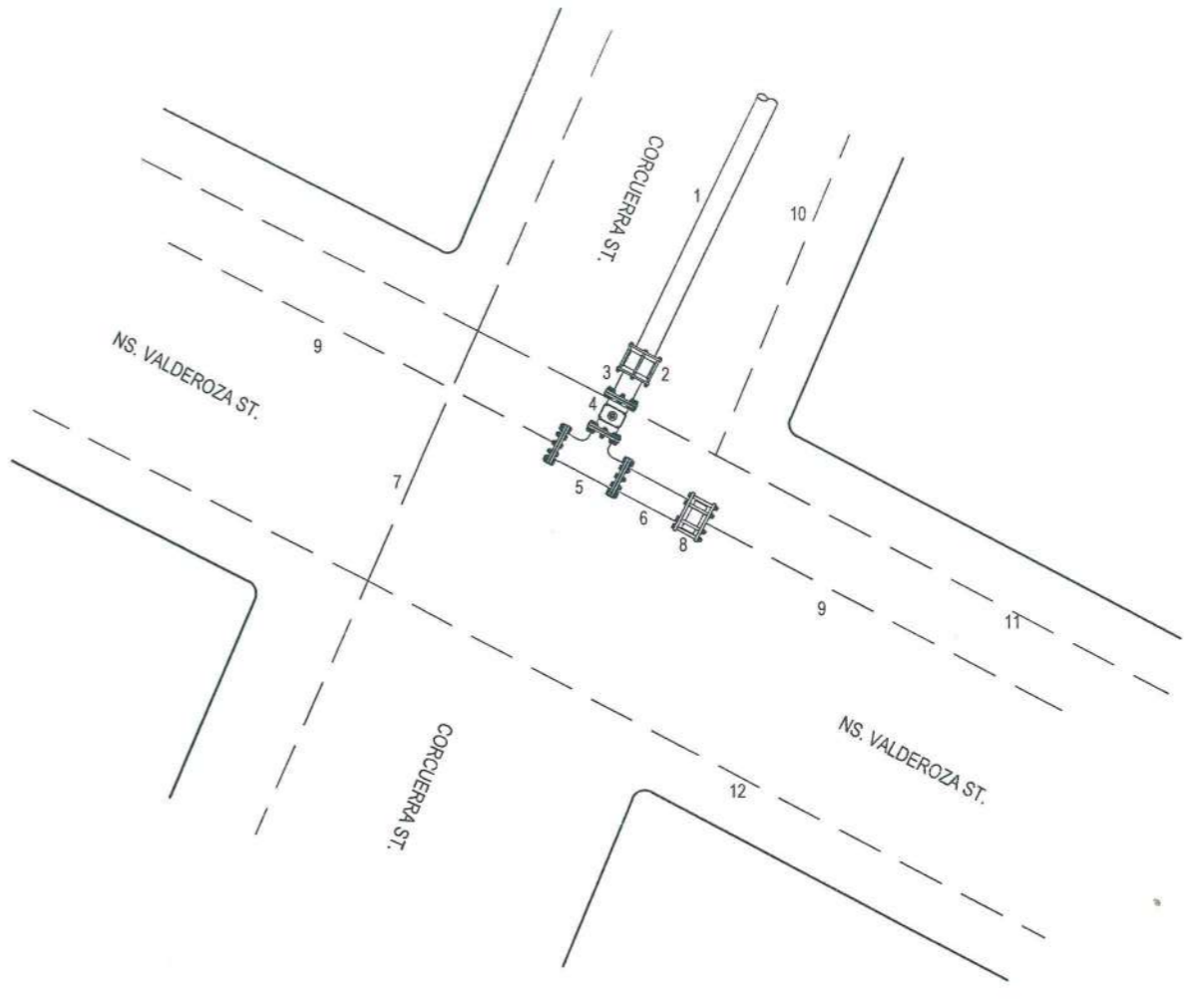

D3

LEGEND:

- 1 - PROP. 254.23 LN. M. 150mmØ PVC PIPELINE, CLASS 150
- 2 - PROP. 150mmØ C.I. SLEEVE TYPE FLEXIBLE COUPLING, (C.I.-PVC)
- 3 - PROP. 150mmØ C.I. ADAPTOR, F/P
- 4 - PROP. 150mmØ C.I. BODY GATE VALVE, F/F
- 5 - PROP. 200mmØ x 150mmØ C.I. TEE, M/F
- 6 - PROP. 200mmØ PVC SHORT PIPE, CLASS 150
- 7 - EXISTING 100mmØ PVC PIPELINE
- 8 - PROP. 200mmØ C.I. SLEEVE TYPE FLEXIBLE COUPLING, (PVC)
- 9 - PROP. 200mmØ PVC PIPELINE, CLASS 150 (UNDER MAINLINE REPLACEMENT PROGRAM (LGU FUNDED) PHASE 1)
- 10 - EXISTING 100mmØ CLCI PIPELINE (FOR DECOMMISSION)
- 11 - EXISTING 200mmØ CLCI PIPELINE
- 12 - EXISTING 150mmØ PVC PIPELINE

INTER-CONNECTION DETAIL OF CORCUERRA ST.
SCALE: NTS

	PREPARED BY: VERLIN ANN B. LACASTESANTOS-LORIA <small>SENIOR ENGINEER-IN-CHARGE DESIGN DIVISION</small>	 LEONAR S. ALCALA, CE <small>ENGINEER IN-CHARGE DESIGN DIVISION</small>	 MICHEL A. FRANCISCO <small>ENGINEER IN-CHARGE D/C, CHIEF PLANNING, DESIGNING AND PROGRAMMING DIVISION, ZOWD</small>	RECOMMENDING APPROVAL: MICHAEL C. PALANCA, CE <small>ENGINEER IN-CHARGE D/C ASSISTANT CHIEF ENGINEER, ZOWD</small>	APPROVED FOR PROJECT IMPLEMENTATION: CHRISTOPHER B. NAVARRO <small>CITY ENGINEER, ZOWD</small>	PROJECT: MAINLINE REPLACEMENT PROGRAM (LGU FUNDED) PHASE 2	SHEET NO: 07	
	SHEET CONTENT: AS INDICATED							

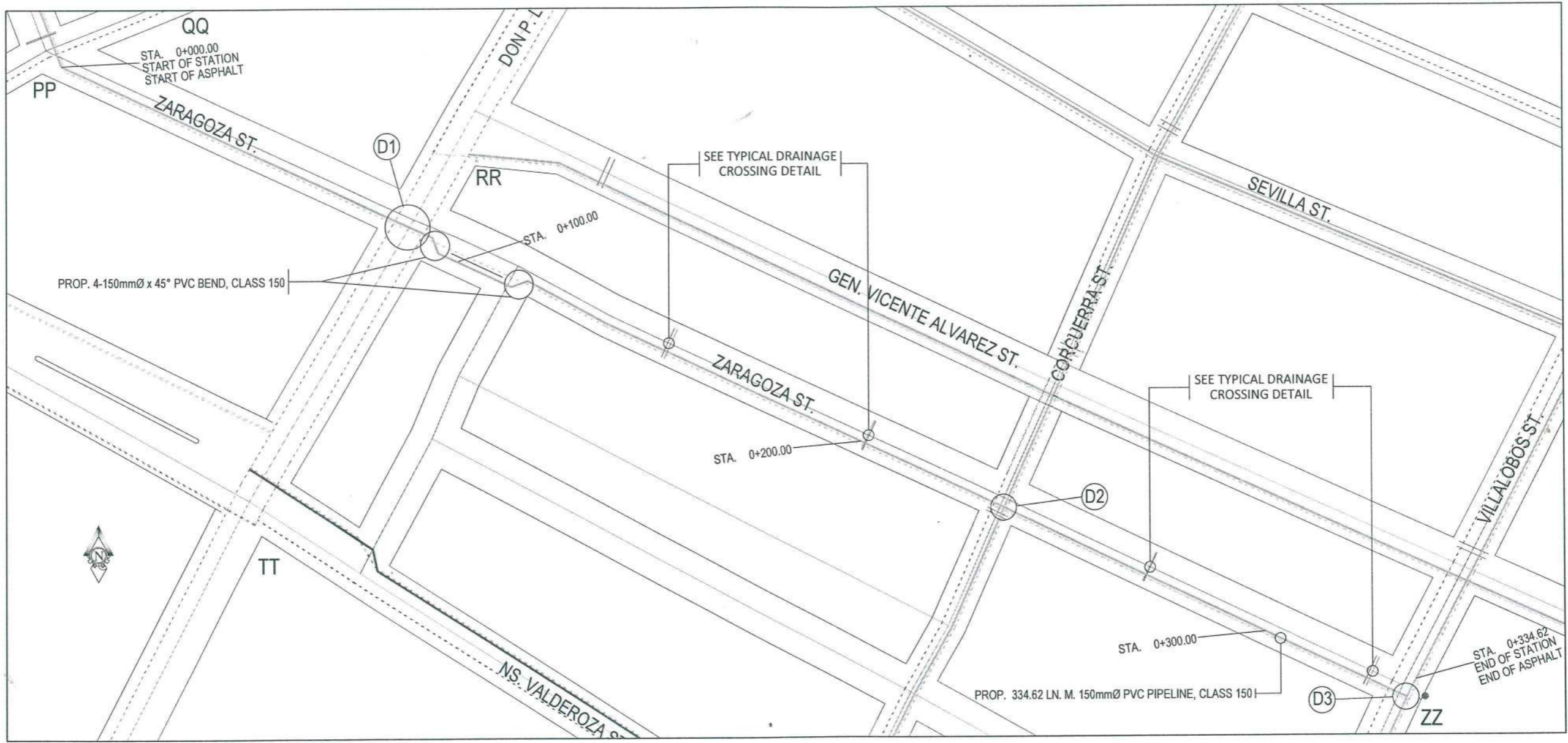

(ZARAGOZA ST.)
SITE DEVELOPMENT PLAN
 SCALE: 1:10m

ZARAGOZA ST.

	PREPARED BY: BUNNY L. DAMPIOS <small>SENIOR ENGINEER A/CE DESIGN DIVISION</small>	 LEONARD S. ALCALA, CE <small>ENGINEER II, CEO</small>	 MICHAEL A. FRANCISCO <small>ENGINEER III, CEO DIC, CHIEF PLANNING, DESIGNING AND PROGRAMMING DIVISION, CDO</small>	RECOMMENDING APPROVAL: MICHAEL C. PALANCA, CE <small>REGISTERED OIC ASSISTANT CITY ENGINEER, CDO</small>	APPROVED FOR PROJECT IMPLEMENTATION: CHRISTOPHER V. NAVARRO <small>REGISTERED City Engineer 11.24. 2023, 08.28</small>	PROJECT: MAINLINE REPLACEMENT PROGRAM (LGU FUNDED) PHASE 2	SHEET NO.: 08
	 VERLIN ANN B. LACASTESANTOS-LORIA <small>SENIOR ENGINEER A/CE DESIGN DIVISION</small>	 REY D. SALE JR., CE <small>REGISTERED ENGINEER A DESIGN DIVISION, ZCWD</small>	 EDITO M. BAUTISTA JR., CE <small>OFFICER IN CHARGE DESIGN DIVISION, ZCWD</small>	 MARLI P. ACOSTA-DE FIESTA <small>DIVISION ENGINEERING & CONSTRUCTION DEPARTMENT OIC - TECHNICAL SERVICES GROUP, ZCWD</small>	 REYNALDO R. CABALIN <small>ACTING GENERAL MANAGER, ZCWD</small>	SHEET CONTENT: AS INDICATED	

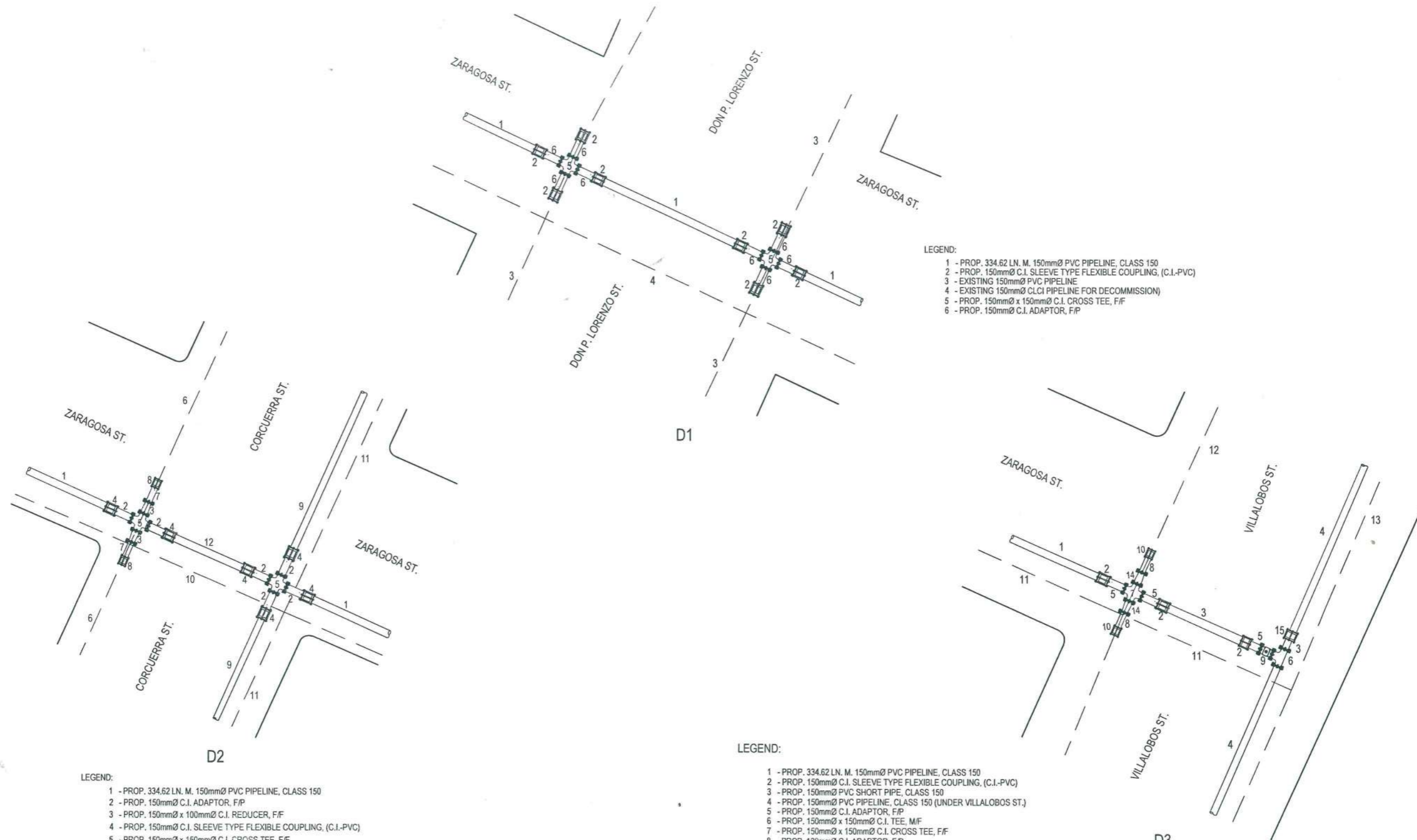

- LEGEND:
- 1 - PROP. 334.62 LN. M. 150mmØ PVC PIPELINE, CLASS 150
 - 2 - PROP. 150mmØ C.I. SLEEVE TYPE FLEXIBLE COUPLING, (C.I.-PVC)
 - 3 - EXISTING 150mmØ PVC PIPELINE
 - 4 - EXISTING 150mmØ CLCI PIPELINE (FOR DECOMMISSION)
 - 5 - PROP. 150mmØ x 150mmØ C.I. CROSS TEE, F/F
 - 6 - PROP. 150mmØ C.I. ADAPTOR, F/F

- LEGEND:
- 1 - PROP. 334.62 LN. M. 150mmØ PVC PIPELINE, CLASS 150
 - 2 - PROP. 150mmØ C.I. ADAPTOR, F/F
 - 3 - PROP. 150mmØ x 100mmØ C.I. REDUCER, F/F
 - 4 - PROP. 150mmØ C.I. SLEEVE TYPE FLEXIBLE COUPLING, (C.I.-PVC)
 - 5 - PROP. 150mmØ x 150mmØ C.I. CROSS TEE, F/F
 - 6 - EXISTING 100mmØ PVC PIPELINE
 - 7 - PROP. 100mmØ C.I. ADAPTOR, F/F
 - 8 - PROP. 100mmØ C.I. SLEEVE TYPE FLEXIBLE COUPLING, (C.I.-PVC)
 - 9 - PROP. 150mmØ PVC PIPELINE, CLASS 150 (UNDER CORCUERRA ST.)
 - 10 - EXISTING 150mmØ CLCI PIPELINE (FOR DECOMMISSION)
 - 11 - EXISTING 100mmØ CLCI PIPELINE
 - 12 - PROP. 150mmØ PVC SHORT PIPE, CLASS 150

- LEGEND:
- 1 - PROP. 334.62 LN. M. 150mmØ PVC PIPELINE, CLASS 150
 - 2 - PROP. 150mmØ C.I. SLEEVE TYPE FLEXIBLE COUPLING, (C.I.-PVC)
 - 3 - PROP. 150mmØ PVC SHORT PIPE, CLASS 150
 - 4 - PROP. 150mmØ PVC PIPELINE, CLASS 150 (UNDER VILLALOBOS ST.)
 - 5 - PROP. 150mmØ C.I. ADAPTOR, F/F
 - 6 - PROP. 150mmØ x 150mmØ C.I. TEE, M/F
 - 7 - PROP. 150mmØ x 150mmØ C.I. CROSS TEE, F/F
 - 8 - PROP. 100mmØ C.I. ADAPTOR, F/F
 - 9 - PROP. 150mmØ C.I. BODY GATE VALVE, F/F
 - 10 - PROP. 100mmØ C.I. SLEEVE TYPE FLEXIBLE COUPLING, (C.I.-PVC)
 - 11 - EXISTING 150mmØ CLCI PIPELINE (FOR DECOMMISSION)
 - 12 - EXISTING 100mmØ PVC PIPELINE
 - 13 - EXISTING 100mmØ CLCI PIPELINE
 - 14 - PROP. 150mmØ x 100mmØ C.I. REDUCER, F/F
 - 15 - PROP. 150mmØ C.I. SLEEVE TYPE FLEXIBLE COUPLING, (PVC)

INTER-CONNECTION DETAIL ZARAGOZA ST.
SCALE: NTS

	PREPARED BY: BUNNY L. DAMPIOS SENIOR ENGINEER A/C DESIGN DIVISION	 LEONARD S. ALCALA, CE ENGINEER II, CEO	 MICHAEL A. FRANCISCO ENGINEER II, CEO <small>OIC, CHIEF PLANNING, DESIGNING AND PROGRAMMING DIVISION, CEO</small>	 MICHAEL C. PALANCA, CE ENGINEER II, CEO <small>OIC, ASSISTANT CITY ENGINEER, CEO</small>	 CHRISTIAN E. NAVARRO ENGINEER II, CEO <small>OIC, ASSISTANT CITY ENGINEER, CEO</small>	PROJECT: MAINLINE REPLACEMENT PROGRAM (LGU FUNDED) PHASE 2	SHEET NO: 09	
	 VERLIN ANN B. LACASTESANTOS-LORIA SENIOR ENGINEER A/C DESIGN DIVISION	 REX D. SALE JR., CE SENIOR ENGINEER A/C DESIGN DIVISION, ZOWD	 EDITO M. BAUTISTA JR., CE OFFICER-IN-CHARGE DESIGN DIVISION, ZOWD	 MARLI P. ACOSTA-DE FIESTA DWA, ENGINEERING & CONSTRUCTION DEPARTMENT <small>OIC - TECHNICAL SERVICES GROUP, ZOWD</small>	 REYNALDO R. CABILIN ACTING GENERAL MANAGER, ZOWD	SHEET CONTENT: AS INDICATED		

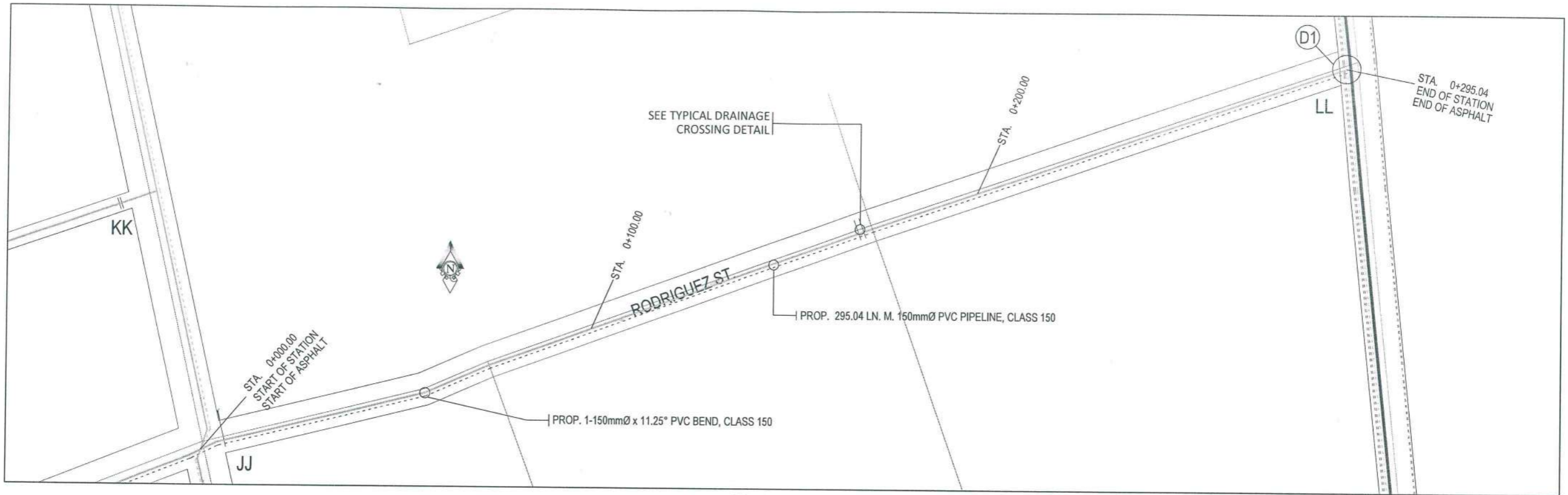

(RODRIGUEZ ST.)
SITE DEVELOPMENT PLAN
 SCALE: 1:10m

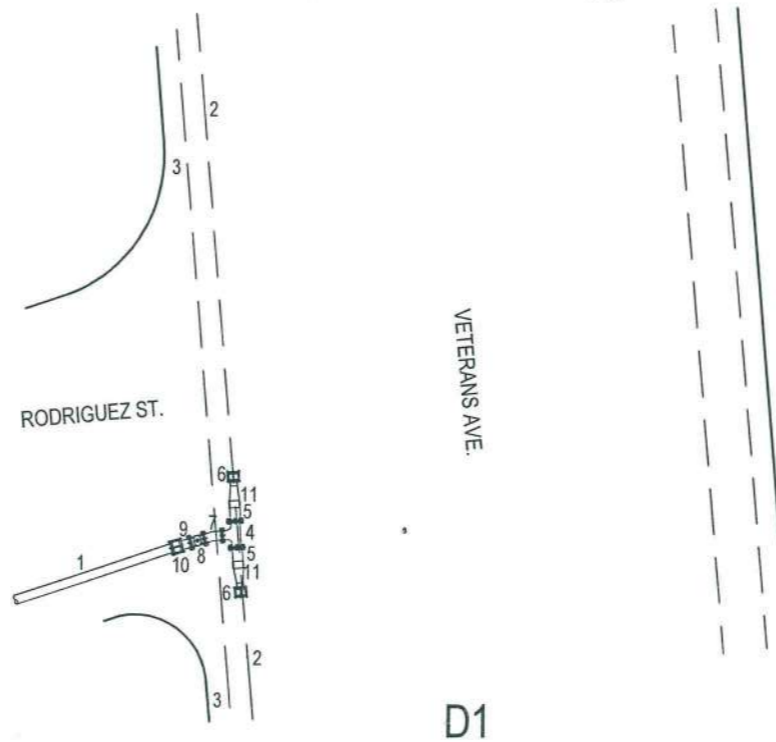

INTER-CONNECTION DETAIL
 SCALE: NTS

LEGEND:

- 1- PROP. 295.04 LN. M. 150MMØ PVC PIPELINE, CLASS 150
- 2- EXIST. 100MMØ CLCI PIPELINE
- 3- EXIST. 400MMØ CLCS PIPELINE
- 4- PROP. 150MMØ X 150MMØ C.I. TEE, M/F
- 5- PROP. 150MMØ CLASS 150, PVC SHORT PIPE
- 6- PROP. 100MMØ C.I. SLEEVE TYPE FLEXIBLE COUPLING, (C.I.-PVC)
- 7- PROP. 150MMØ X 11.25° C.I. BEND, F/F
- 8- PROP. 150MMØ C.I. BODY GATE VALVE, F/F
- 9- PROP. 150MMØ C.I. ADAPTOR, F/P
- 10- PROP. 150MMØ C.I. SLEEVE TYPE FLEXIBLE COUPLING, (C.I.-PVC)
- 11- PROP. 150MMØ x 100MMØ PVC REDUCER, CLASS 150

RODRIGUEZ ST.



PREPARED BY:

BUNNY L. DAMPIOS
 SENIOR ENGINEER & CE
 DESIGN DIVISION

VERLIN ANN B. LACASTESANTOS-LORIA
 SENIOR ENGINEER & CE
 DESIGN DIVISION

LEONARD S. ALCALA, CE
 ENGINEER II, CEO

REX D. SALE JR., CE
 ASSISTING ENGINEER &
 DESIGN DIVISION, ZCWD

MICHAEL A. FRANCISCO
 ENGINEER II, CEO
 OIC, CHIEF PLANNING, DESIGNING AND PROGRAMMING DIVISION, ZCWD

EDITO M. BAUTISTA JR., CE
 OFFICER IN CHARGE
 DESIGN DIVISION, ZCWD

RECOMMENDING APPROVAL:

MICHAEL C. PALANCA, CE
 ENGINEER II
 OIC ASSISTANT CITY ENGINEER, CEO

MARI P. ACOSTA-DE FIESTA
 OMA, ENGINEERING & CONSTRUCTION DEPARTMENT
 OIC TECHNICAL SERVICES GROUP, ZCWD

APPROVED FOR PROJECT IMPLEMENTATION:

CHRISTOPHER O. NAVARRO
 ENGINEER II
 OIC ASSISTANT CITY ENGINEER, CEO

REYNALDO R. CABILIN
 ACTING GENERAL MANAGER, ZCWD

PROJECT:

**MAINLINE REPLACEMENT PROGRAM
 (LGU FUNDED) PHASE 2**

SHEET CONTENT:

AS INDICATED

SHEET NO.:

10



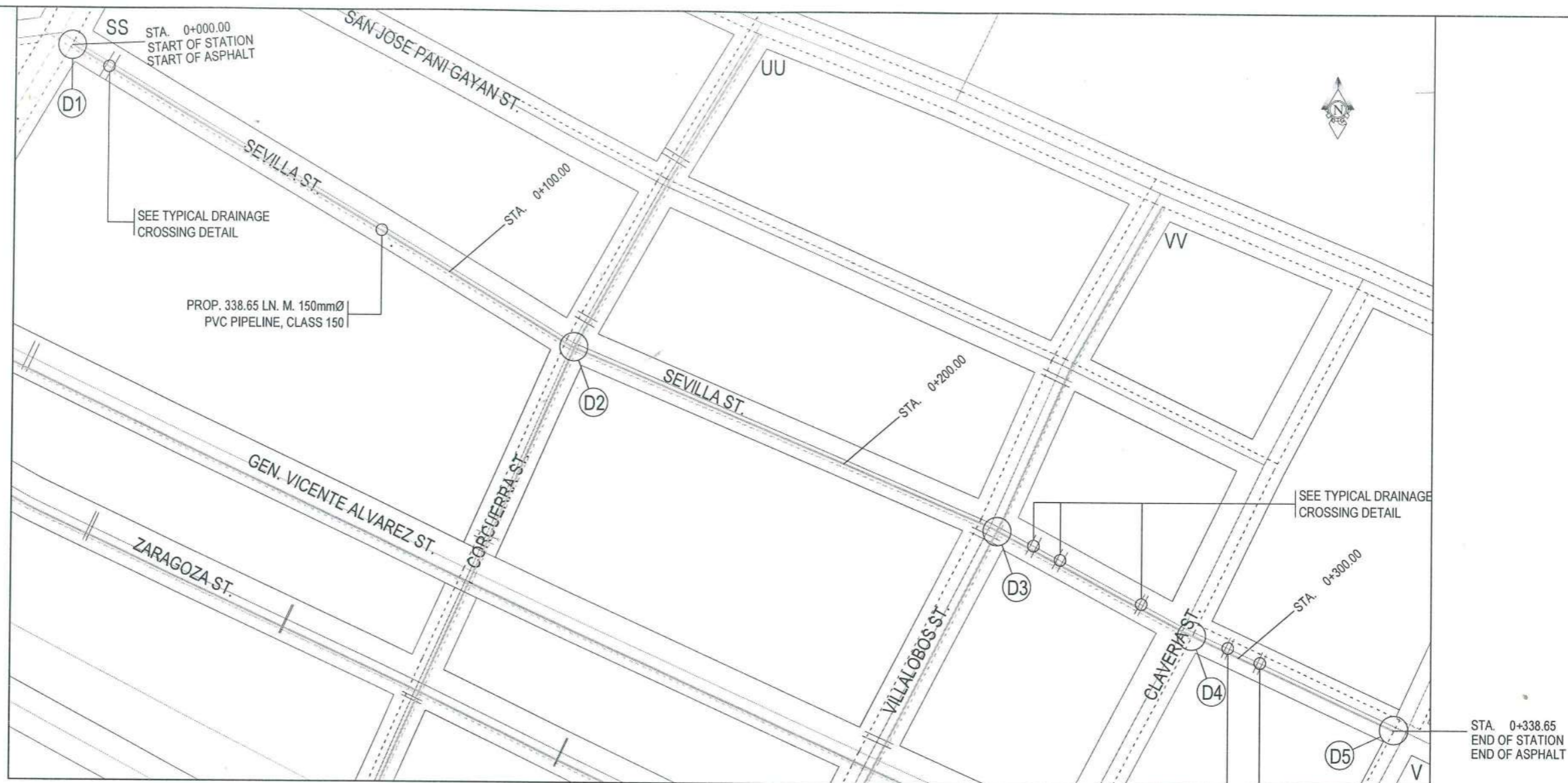

(SEVILLA ST.)
SITE DEVELOPMENT PLAN
SCALE: 1:11m



INTER-CONNECTION DETAIL
SCALE: NTS

LEGEND:

- 1 - PROP. 338.65 LN. M. 150mmØ PVC PIPELINE, CLASS 150
- 2 - PROP. 150mmØ C.I. SLEEVE TYPE FLEXIBLE COUPLING (C.I.-PVC)
- 3 - PROP. 150mmØ C.I. ADAPTOR, F/F
- 4 - PROP. 150mmØ C.I. BODY GATE VALVE, F/F
- 5 - PROP. 150mmØ x 150mmØ C.I. TEE, M/F
- 6 - PROP. 150mmØ C.I. SLEEVE TYPE FLEXIBLE COUPLING (PVC)
- 7 - PROP. 150mmØ PVC SHORT PIPE, CLASS 150
- 8 - EXISTING 100mmØ CLCI PIPELINE (FOR DECOMMISSION)
- 9 - EXISTING 150mmØ PVC PIPELINE

SEVILLA ST.

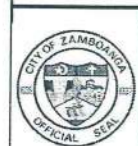

PREPARED BY:

BUNNY L. DAMPIG
SENIOR ENGINEER A.C.E.
DESIGN DIVISION

VERLIN ANN B. LACASTESANTOS-LORIA
SENIOR ENGINEER A.C.E.
DESIGN DIVISION

LEONARDO S. ALCALA, CE
ENGINEER II, C.E.O.

REX D. SALE JR., CE
PROFESSOR ENGINEER A.C.E.
DESIGN DIVISION, ZCWD

MICHAEL A. FRANCISCO
ENGINEER II, C.E.O.
D/C, CHIEF PLANNING, DESIGNING AND PROGRAMMING DIVISION, C.E.O.

EDITH M. BAUTISTA JR., CE
OFFICER IN CHARGE
DESIGN DIVISION, ZCWD

RECOMMENDING APPROVAL:

MICHAEL S. PALANCA, CE
ENGINEER II
D/C ASSISTANT CITY ENGINEER, C.E.O.

MARLI P. ACOSTA-DE FIESTA
D/M A. ENGINEERING & CONSTRUCTION DEPARTMENT
D/C TECHNICAL SERVICES GROUP, ZCWD

APPROVED FOR PROJECT IMPLEMENTATION:

CHRISTOPHER O. NAVARRO
ENGINEER II, C.E.O.

REYNALDO R. CABILIN
ACTING GENERAL MANAGER, ZCWD

PROJECT:

**MAINLINE REPLACEMENT PROGRAM
(LGU FUNDED) PHASE 2**

SHEET CONTENT:

AS INDICATED

SHEET NO:

11



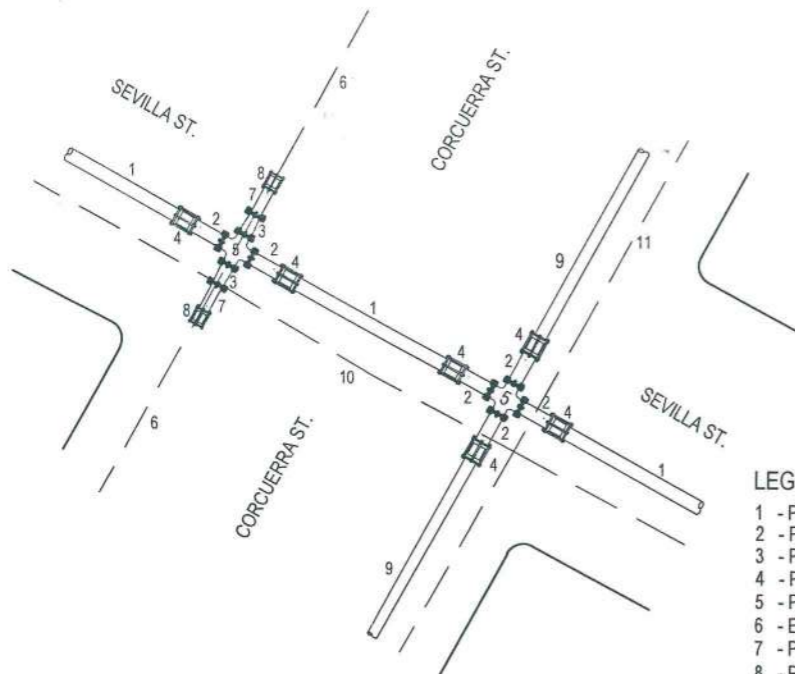

- LEGEND:**
- 1 - PROP. 338.65 LN. M. 150mmØ PVC PIPELINE, CLASS 150
 - 2 - PROP. 150mmØ C.I. ADAPTOR, F/P
 - 3 - PROP. 150mmØ x 100mmØ C.I. REDUCER, F/F
 - 4 - PROP. 150mmØ C.I. SLEEVE TYPE FLEXIBLE COUPLING, (C.I.-PVC)
 - 5 - PROP. 150mmØ x 150mmØ C.I. CROSS TEE, F/F
 - 6 - EXISTING 100mmØ PVC PIPELINE
 - 7 - PROP. 100mmØ C.I. ADAPTOR, F/P
 - 8 - PROP. 100mmØ C.I. SLEEVE TYPE FLEXIBLE COUPLING, (C.I.-PVC)
 - 9 - PROP. 150mmØ PVC PIPELINE, CLASS 150 (UNDER CORCUERRA ST.)
 - 10 - EXISTING 100mmØ CLCI PIPELINE (FOR DECOMMISSION)
 - 11 - EXISTING 100mmØ CLCI PIPELINE

- LEGEND:**
- 1 - PROP. 338.65 LN. M. 150mmØ PVC PIPELINE, CLASS 150
 - 2 - PROP. 150mmØ C.I. ADAPTOR, F/P
 - 3 - PROP. 150mmØ x 100mmØ C.I. REDUCER, F/F
 - 4 - PROP. 150mmØ C.I. SLEEVE TYPE FLEXIBLE COUPLING, (C.I.-PVC)
 - 5 - PROP. 150mmØ x 150mmØ C.I. CROSS TEE, F/F
 - 6 - EXISTING 100mmØ PVC PIPELINE
 - 7 - PROP. 100mmØ C.I. ADAPTOR, F/P
 - 8 - PROP. 100mmØ C.I. SLEEVE TYPE FLEXIBLE COUPLING, (C.I.-PVC)
 - 9 - PROP. 150mmØ PVC PIPELINE, CLASS 150 (UNDER CORCUERRA ST.)
 - 10 - EXISTING 100mmØ CLCI PIPELINE (FOR DECOMMISSION)
 - 11 - EXISTING 100mmØ CLCI PIPELINE

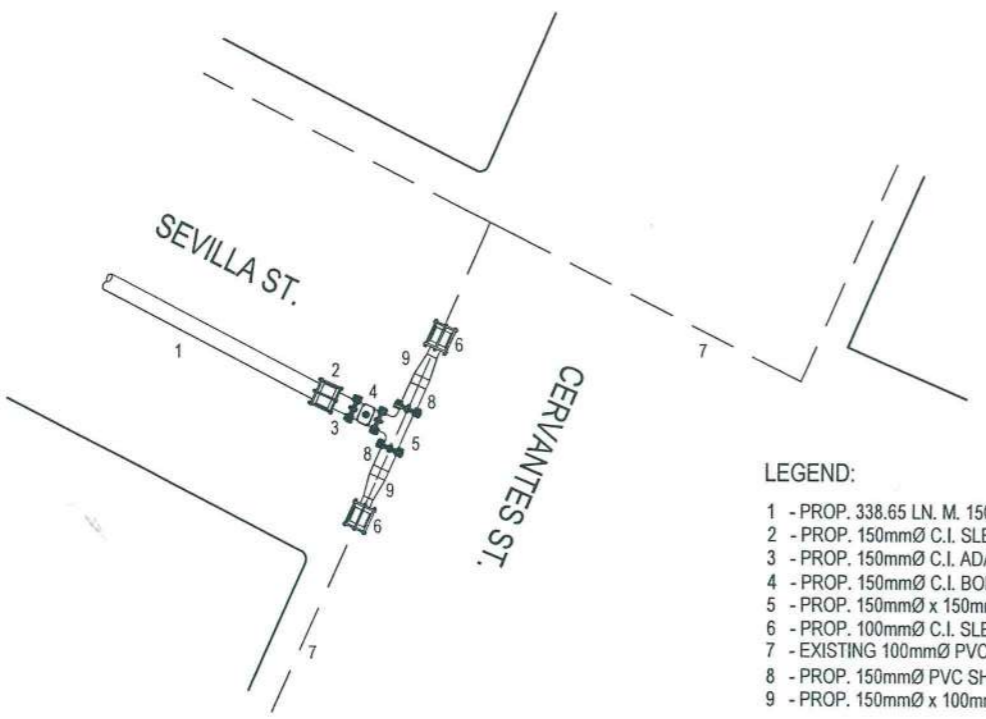
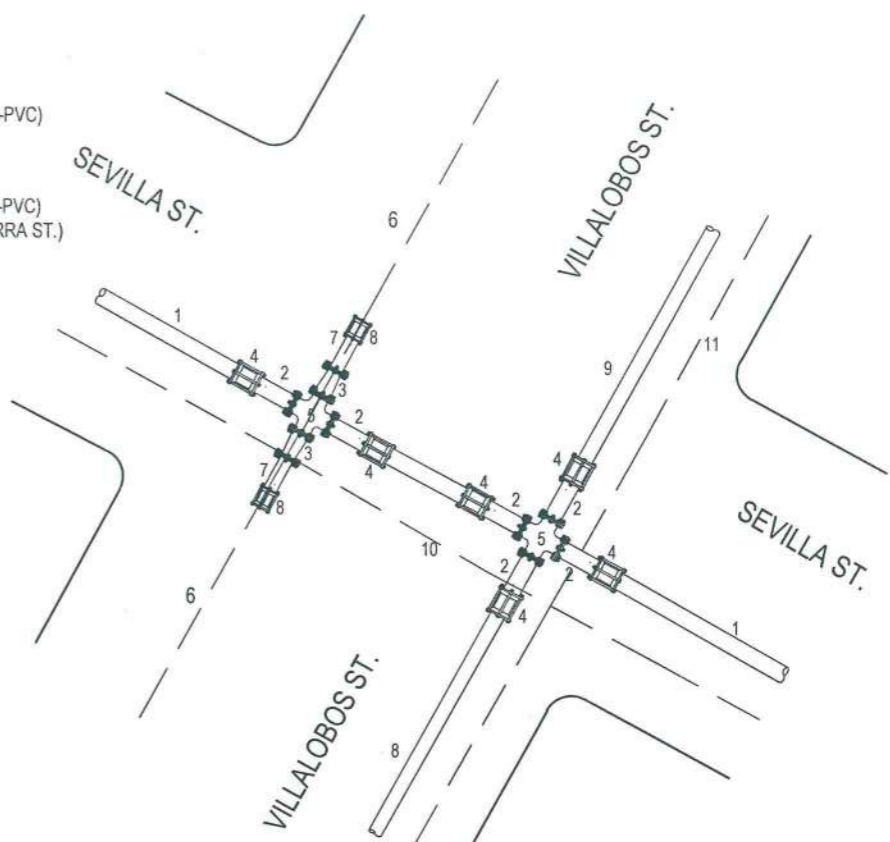

- LEGEND:**
- 1 - PROP. 338.65 LN. M. 150mmØ PVC PIPELINE, CLASS 150
 - 2 - PROP. 150mmØ C.I. SLEEVE TYPE FLEXIBLE COUPLING (C.I.-PVC)
 - 3 - PROP. 150mmØ C.I. ADAPTOR, F/P
 - 4 - PROP. 150mmØ C.I. BODY GATE VALVE, F/F
 - 5 - PROP. 150mmØ x 150mmØ C.I. TEE, M/F
 - 6 - PROP. 100mmØ C.I. SLEEVE TYPE FLEXIBLE COUPLING (PVC)
 - 7 - EXISTING 100mmØ PVC PIPELINE
 - 8 - PROP. 150mmØ PVC SHORT PIPE, CLASS 150
 - 9 - PROP. 150mmØ x 100mmØ PVC REDUCER, CLASS 150

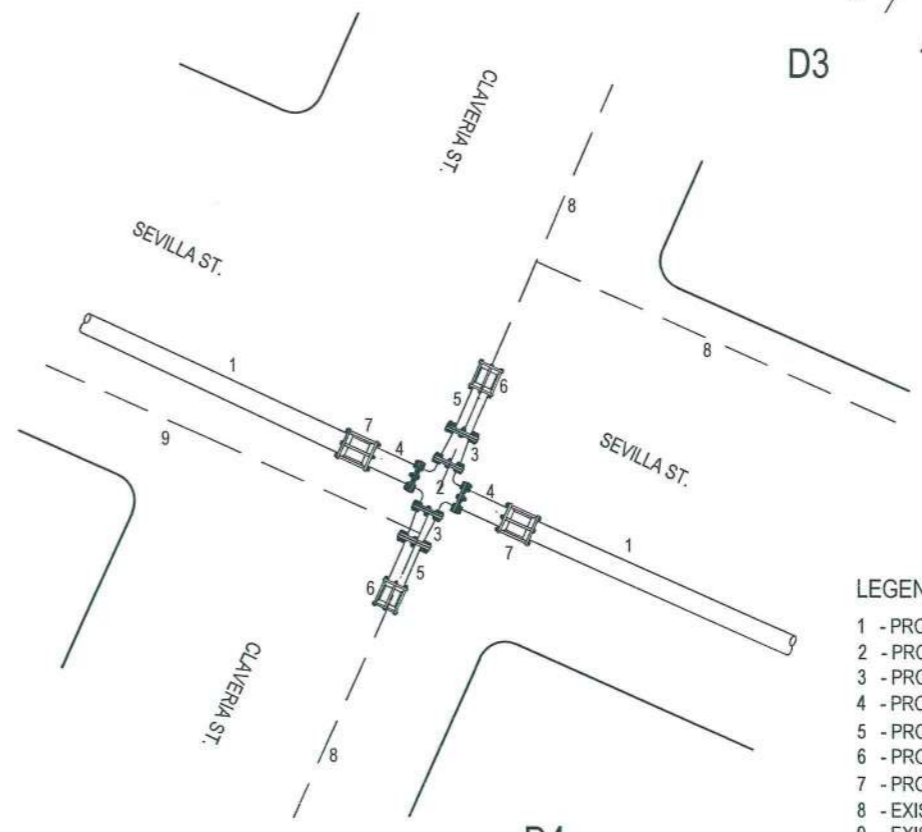

- LEGEND:**
- 1 - PROP. 338.65 LN. M. 150mmØ PVC PIPELINE, CLASS 150
 - 2 - PROP. 150mmØ x 150mmØ C.I. CROSS TEE, F/F
 - 3 - PROP. 150mmØ x 100mmØ C.I. REDUCER, F/F
 - 4 - PROP. 150mmØ C.I. ADAPTOR, F/P
 - 5 - PROP. 100mmØ C.I. ADAPTOR, F/P
 - 6 - PROP. 100mmØ C.I. SLEEVE TYPE FLEXIBLE COUPLING, (C.I.-PVC)
 - 7 - PROP. 150mmØ C.I. SLEEVE TYPE FLEXIBLE COUPLING, (C.I.-PVC)
 - 8 - EXISTING 100mmØ PVC PIPELINE
 - 9 - EXISTING 100mmØ CLCI PIPELINE (FOR DECOMMISSION)

INTER-CONNECTION DETAIL OF SEVILLA ST.
SCALE: _____ NTS

	PREPARED BY: BUNNY L. DAMPIOS SENIOR ENGINEER & CE DESIGN DIVISION VERLIN ANN B. LACASTESANTOS-LORIA SENIOR ENGINEER & CE DESIGN DIVISION	 LEONARDO S. ALCALA, CE ENGINEER II, CEO REX D. SALE JR., CE SUPERVISING ENGINEER & DESIGN DIVISION, ZWD	RECOMMENDING APPROVAL: MICHAEL A. FRANCISCO ENGINEER II, CEO CHIEF PLANNING, DESIGN AND PROGRAMMING DIVISION, CDO EDITO M. BAUTISTA JR., CE OFFICER-IN-CHARGE DESIGN DIVISION, ZWD	APPROVED FOR PROJECT IMPLEMENTATION: MICHAEL C. PALANCA, CE ENGINEER II DEPUTY CHIEF ENGINEER, CDO MARLI P. ACOSTA-DE FIESTA DMA- ENGINEERING & CONSTRUCTION DEPARTMENT CIO- TECHNICAL SERVICES GROUP, ZWD	APPROVED FOR PROJECT IMPLEMENTATION: CHRISTOPHER O. NAVARRO CITY ENGINEER REYNALDO R. CABILIN ACTING GENERAL MANAGER, ZWD	PROJECT: MAINLINE REPLACEMENT PROGRAM (LGU FUNDED) PHASE 2 SHEET CONTENT: AS INDICATED	SHEET NO: 12	
--	---	---	--	--	---	--	------------------------	--