

**SITE DEVELOPMENT PLAN**  
SCALE: 1:250

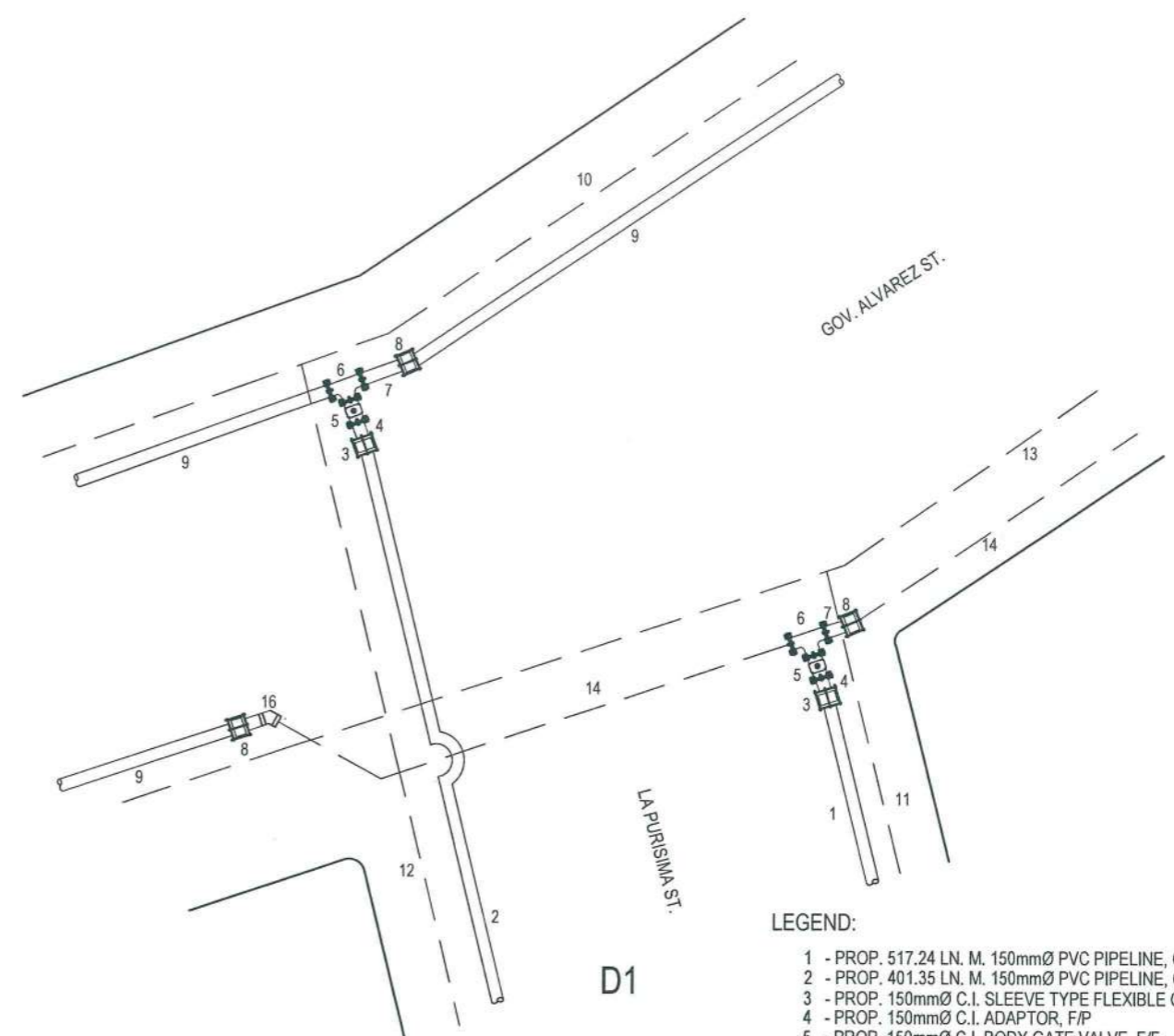

**INTER-CONNECTION DETAIL OF LAPURISIMA ST.**  
SCALE: NTS

**LEGEND:**

- 1 - PROP. 517.24 LN. M. 150mmØ PVC PIPELINE, CLASS 150
- 2 - PROP. 401.35 LN. M. 150mmØ PVC PIPELINE, CLASS 150
- 3 - PROP. 150mmØ C.I. SLEEVE TYPE FLEXIBLE COUPLING (C.I.-PVC)
- 4 - PROP. 150mmØ C.I. ADAPTOR, F/P
- 5 - PROP. 150mmØ C.I. BODY GATE VALVE, F/F
- 6 - PROP. 150mmØ x 150mmØ C.I. TEE, M/F
- 7 - PROP. 150mmØ PVC SHORT PIPE, CLASS 150
- 8 - PROP. 150mmØ C.I. SLEEVE TYPE FLEXIBLE COUPLING (PVC)
- 9 - PROP. 150mmØ PVC PIPELINE, CLASS 150 (UNDER GOV. ALVAREZ ST.)
- 10 - EXISTING 100mmØ C.I. PIPELINE
- 11 - EXISTING 100mmØ C.I. PIPELINE (FOR DECOMMISSION)
- 12 - EXISTING 100mmØ ACP PIPELINE (FOR DECOMMISSION)
- 13 - EXISTING 150mmØ C.I. PIPELINE
- 14 - EXISTING 150mmØ PVC PIPELINE, CLASS 150
- 15 - PROP. 150mmØ PVC PIPELINE, CLASS 150
- 16 - PROP. 150mmØ x 45° PVC BEND, CLASS 150

**LAPURISIMA ST.**

	PREPARED BY:  <b>BUNNY L. DAMPAS</b> <small>SENIOR ENGINEER A/C DESIGN DIVISION</small>	 <b>LEONARD S. ALCALA, CE</b> <small>ENGINEER II, CEO</small>	 <b>MICHAEL A. FRANCISCO</b> <small>ENGINEER II, CEO OIC, CHIEF PLANNING, DESIGNING AND PROGRAMMING DIVISION, CEO</small>	RECOMMENDING APPROVAL:  <b>MICHAEL O. PALANCA, CE</b> <small>ENGINEER II OIC-ASSISTANT CITY ENGINEER, CEO</small>	APPROVED FOR PROJECT IMPLEMENTATION:  <b>CHRISTOPHER O. NAVARRO</b> <small>CITY ENGINEER, CEO</small>	PROJECT: <b>MAINLINE REPLACEMENT PROGRAM (LGU FUNDED) PHASE 2</b>	SHEET NO: <b>19</b>
	 <b>VERLIN ANN B. LACASTESANTOS-LORIA</b> <small>SENIOR ENGINEER A/C DESIGN DIVISION</small>	 <b>REX D. SALE JR., CE</b> <small>SENIOR ENGINEER A/C DESIGN DIVISION, ZOMB</small>	 <b>EDITO M. BAUTISTA JR., CE</b> <small>OFFICER-IN-CHARGE DESIGN DIVISION, ZOMB</small>	 <b>MARI L.P. ACOSTA-DE FIESTA</b> <small>OFFICER-IN-CHARGE OIC - TECHNICAL SERVICES GROUP, ZOMB</small>	 <b>REYNALDO R. CABILIN</b> <small>ACTING GENERAL MANAGER, ZOMB</small>	SHEET CONTENT: AS INDICATED	



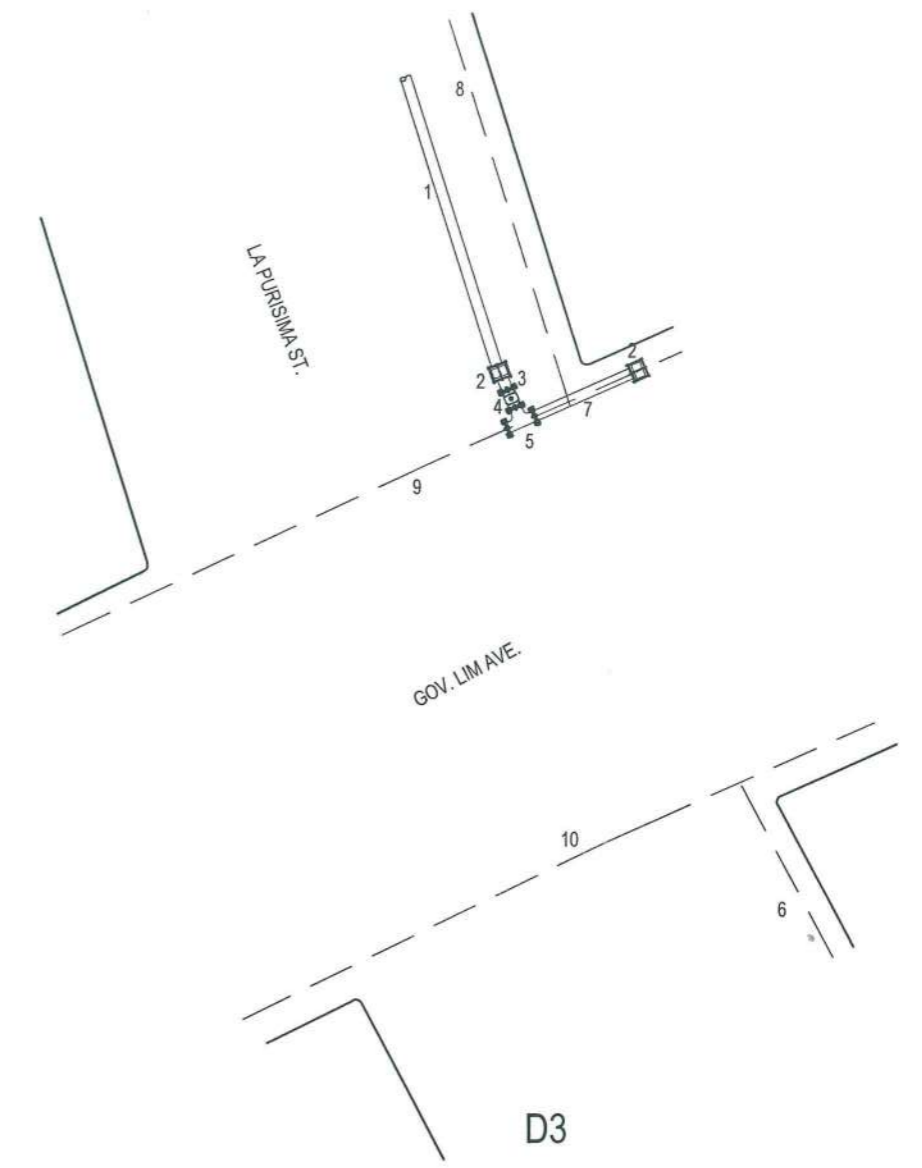
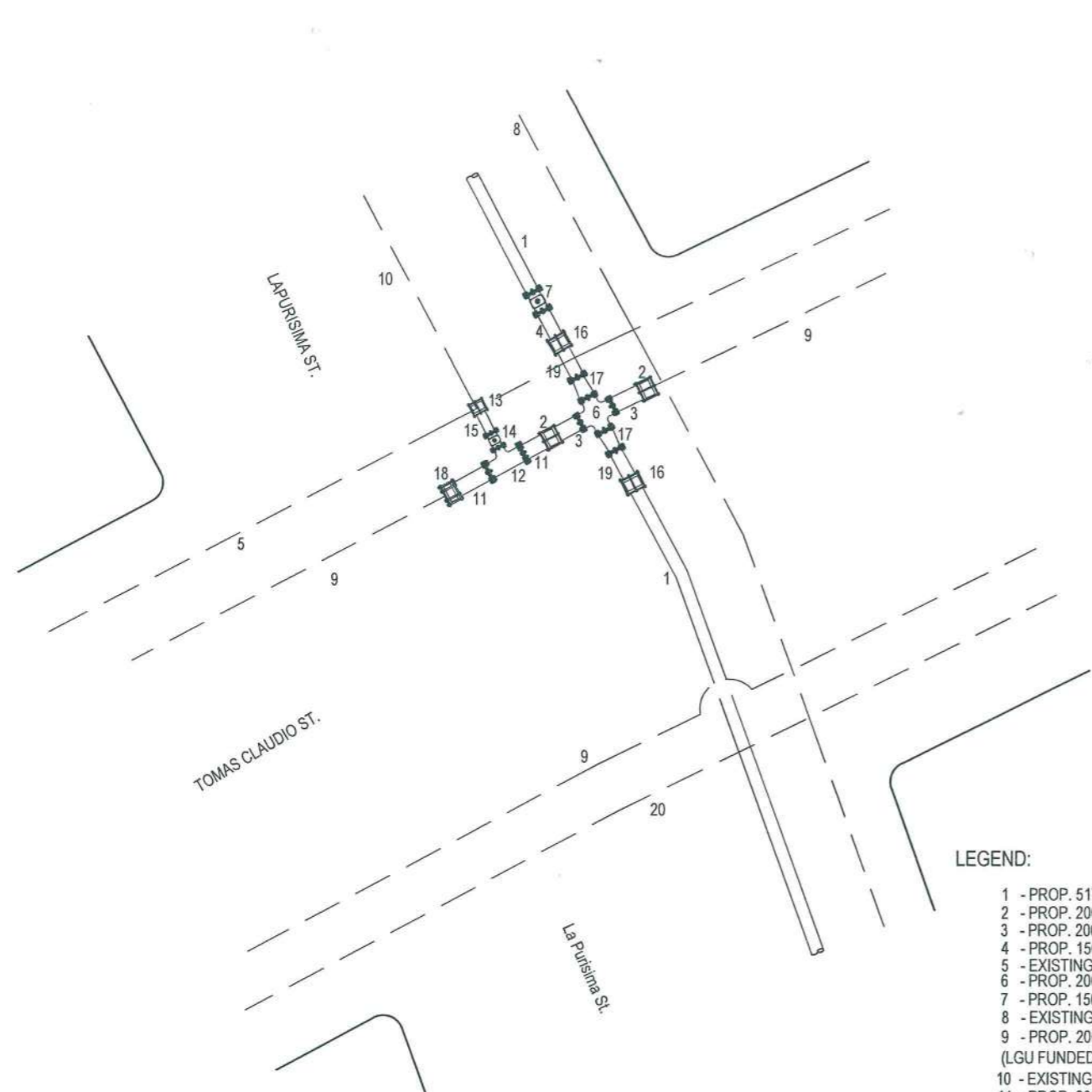

**LEGEND:**











- 1 - PROP. 517.24 LN. M. 150mmØ PVC PIPELINE, CLASS 150
- 2 - PROP. 200mmØ C.I. SLEEVE TYPE FLECIABLE COUPLING (C.I.-PVC)
- 3 - PROP. 200mmØ C.I. ADAPTOR, F/P
- 4 - PROP. 150mmØ PVC SHORT PIPE, CLASS 150
- 5 - EXISTING 200mmØ CLCI PIPELINE
- 6 - PROP. 200mmØ x 200mmØ C.I. CROSS TEE, F/F
- 7 - PROP. 150mmØ C.I. BODY GATE VALVE, M/M
- 8 - EXISTING 100mmØ CLCI PIPELINE (FOR DECOMMISSION)
- 9 - PROP. 200mmØ PVC PIPELINE, CLASS 150 (UNDER MAINLINE REPLACEMENT PROGRAM (LGU FUNDED) PHASE 1)
- 10 - EXISTING 100mmØ CLCI PIPELINE
- 11 - PROP. 200mmØ PVC SHORT PIPE, CLASS 150
- 12 - PROP. 200mmØ x 100mmØ C.I. TEE, M/F
- 13 - PROP. 100mmØ C.I. SLEEVE TYPE FLEXIBLE COUPLING (C.I.)
- 14 - PROP. 100mmØ C.I. BODY GATE VALVE, F/F
- 15 - PROP. 100mmØ C.I. ADAPTOR, F/P
- 16 - PROP. 150mmØ C.I. SLEEVE TYPE FLEXIBLE COUPLING (C.I.-PVC)
- 17 - PROP. 200mmØ x 150mmØ C.I. REDUCER, F/F
- 18 - PROP. 200mmØ C.I. SLEEVE TYPE FLEXIBLE COUPLING (PVC)
- 19 - PROP. 150mmØ C.I. ADAPTOR, F/P
- 20 - EXISTING 100mmØ CLCI PIPELINE

**LEGEND:**

- 1 - PROP. 517.24 LN. M. 150mmØ PVC PIPELINE, CLASS 150
- 2 - PROP. 150mmØ C.I. SLEEVE TYPE FLEXIBLE COUPLING (C.I.-PVC)
- 3 - PROP. 150mmØ C.I. ADAPTOR, F/P
- 4 - PROP. 150mmØ C.I. BODY GATE VALVE, F/F
- 5 - PROP. 150mmØ x 150mmØ C.I. TEE, M/F
- 6 - EXISTING 100mmØ PVC PIPELINE
- 7 - PROP. 150mmØ PVC SHORT PIPE, CLASS 150
- 8 - EXISTING 100mmØ CLCI PIPELINE (FOR DECOMMISSION)
- 9 - EXISTING 150mmØ C.I. PIPELINE
- 10 - EXISTING 150mmØ PVC PIPELINE

**INTER-CONNECTION DETAIL OF LAPURISIMA ST.**

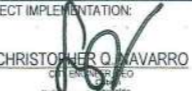
SCALE: NTS

	PREPARED BY:  <b>BUNNY L. DAMPIGS</b> <small>SENIOR ENGINEER A-CR DESIGN DIVISION</small>  <b>VERLIN ANN B. LACASTESANTOS-LORIA</b> <small>SENIOR ENGINEER A-CR DESIGN DIVISION</small>	 <b>LEONARDO S. ALCALA, CE</b> <small>ENGINEER II, CEO</small>  <b>REX D. SALE JR., CE</b> <small>REGISTERED ENGINEER A DESIGN DIVISION, ZCWD</small>	 <b>MICHAEL A. FRANCISCO</b> <small>ENGINEER II, CEO OIC, CHIEF PLANNING, DESIGNING AND PROGRAMMING DIVISION, CEO</small>  <b>EDITO M. BAUTISTA JR., CE</b> <small>OFFICER-IN-CHARGE DESIGN DIVISION, ZCWD</small>	RECOMMENDING APPROVAL:  <b>MICHAEL C. PALANCA, CE</b> <small>ENGINEER II OIC, ASSISTANT CITY ENGINEER, CEO</small>  <b>MARLUP ACOSTA-DE FIESTA</b> <small>DATA ENGINEERING &amp; CONSTRUCTION DEPARTMENT OIC, TECHNICAL SERVICES GROUP, ZCWD</small>	APPROVED FOR PROJECT IMPLEMENTATION:  <b>CHRISTOPHER O. NAVARRO</b> <small>ENGINEER III, CEO</small>  <b>REYNALDO R. CABILIN</b> <small>2020.06.20 11:34 ACTING GENERAL MANAGER, ZCWD</small>	PROJECT: <b>MAINLINE REPLACEMENT PROGRAM (LGU FUNDED) PHASE 2</b> SHEET CONTENT: AS INDICATED	SHEET NO. <b>20</b>	
---	---	---	---	--	---	--	------------------------	---



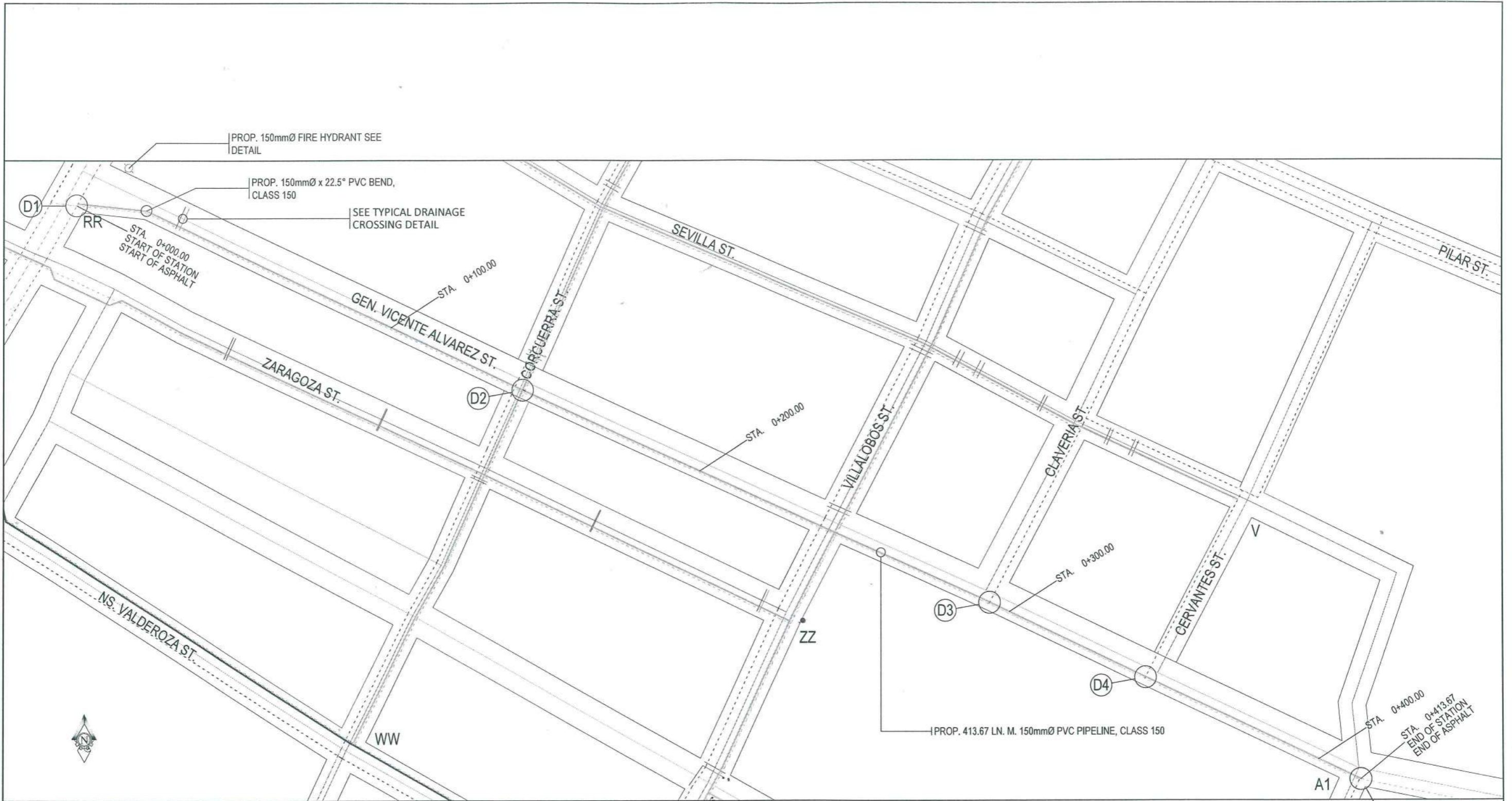

(GEN. VICENTE ALVAREZ ST.)  
**SITE DEVELOPMENT PLAN**  
 SCALE: 1:11m

**GEN. VICENTE ALVAREZ ST.**

	PREPARED BY:  <b>BUNNY L. DAMPIGS</b> SENIOR ENGINEER A.C.E. DESIGN DIVISION	 <b>LEONARDO S. ALCALA, CE</b> ENGINEER, C.E.O.	 <b>MICHAEL A. FRANCISCO</b> ENGINEER, C.E.O. OIC, CHIEF PLANNING AND ZONING AND PROGRAMMING DIVISION, C.E.O.	RECOMMENDING APPROVAL:  <b>MICHAEL C. PALANCA, CE</b> ENGINEER II OIC, ASSISTANT CITY ENGINEER, C.E.O.	APPROVED FOR PROJECT IMPLEMENTATION:  <b>CHRISTOPHER O. NAVARRO</b> CITY ENGINEER, C.E.O.	PROJECT: <b>MAINLINE REPLACEMENT PROGRAM (LGU FUNDED) PHASE 2</b>	SHEET NO: <b>21</b>	
	 <b>VERLIN ANN B. LACASTESANTOS-LORIA</b> SENIOR ENGINEER A.C.E. DESIGN DIVISION	 <b>REX D. SALE, JR., CE</b> SENIOR ENGINEER A.C.E. DESIGN DIVISION, C.E.O.	 <b>EDITO M. BAUTISTA, JR., CE</b> OFFICER IN CHARGE DESIGN DIVISION, C.E.O.	 <b>MARLIP P. ACOSTA-DE FIESTA</b> DATA ENGINEERING & CONSTRUCTION DEPARTMENT OIC, TECHNICAL SERVICES GROUP, C.E.O.	 <b>REYNALDO R. CABILIN</b> ACTING GENERAL MANAGER, C.E.O.	SHEET CONTENT: AS INDICATED		



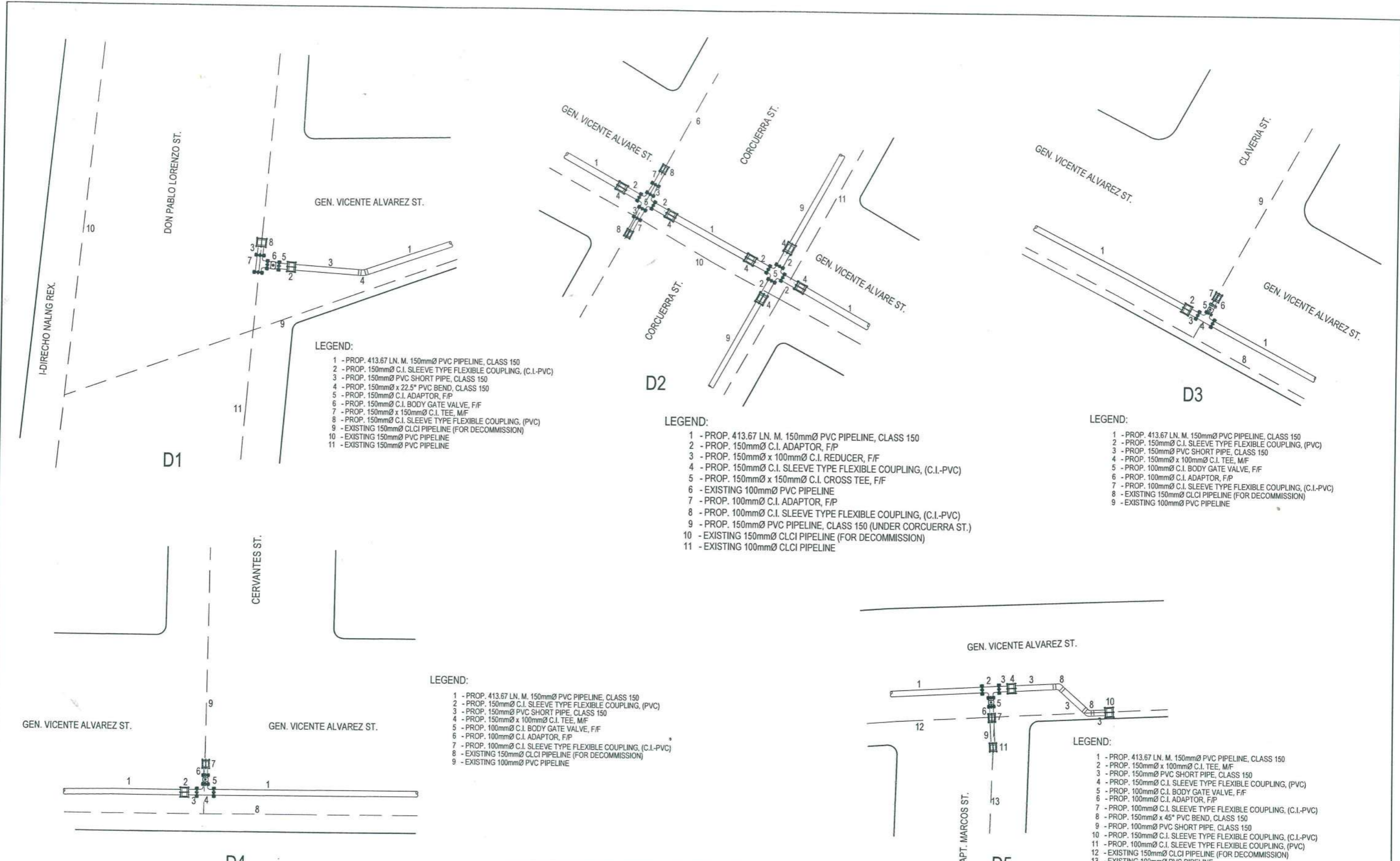

INTERCONNECTION DETAIL OF GEN. VICENTE ALVAREZ ST.  
SCALE: NTS

	PREPARED BY: BUNNY L. DAMPIOS SENIOR ENGINEER A/C E DESIGN DIVISION VERLIN ANN B. LACASTESANTOS-LORIA SENIOR ENGINEER A/C E DESIGN DIVISION	LEONARDO S. ALCALA, CE ENGINEER II, CEO REY D. SALE JR., CE SENIOR ENGINEER A/C E DESIGN DIVISION, ZOWD	MICHAEL C. PALANCA, CE ENGINEER II OIC ASSISTANT CITY ENGINEER, CEO MARLP. ACOSTA-DE FIESTA OIC ASSISTANT CITY ENGINEER, CEO OIC TECHNICAL SERVICES GROUP, ZOWD	APPROVED FOR PROJECT IMPLEMENTATION: CHRISTOPHER C. NAVARRO OIC ASSISTANT CITY ENGINEER, CEO REYNALDO R. CABILIN ACTING GENERAL MANAGER, ZOWD	PROJECT: MAINLINE REPLACEMENT PROGRAM (LGU FUNDED) PHASE 2 SHEET CONTENT: AS INDICATED	SHEET NO: 22	
	CITY OF ZAMBOANGA ZAMBOANGA CITY WATER DISTRICT						

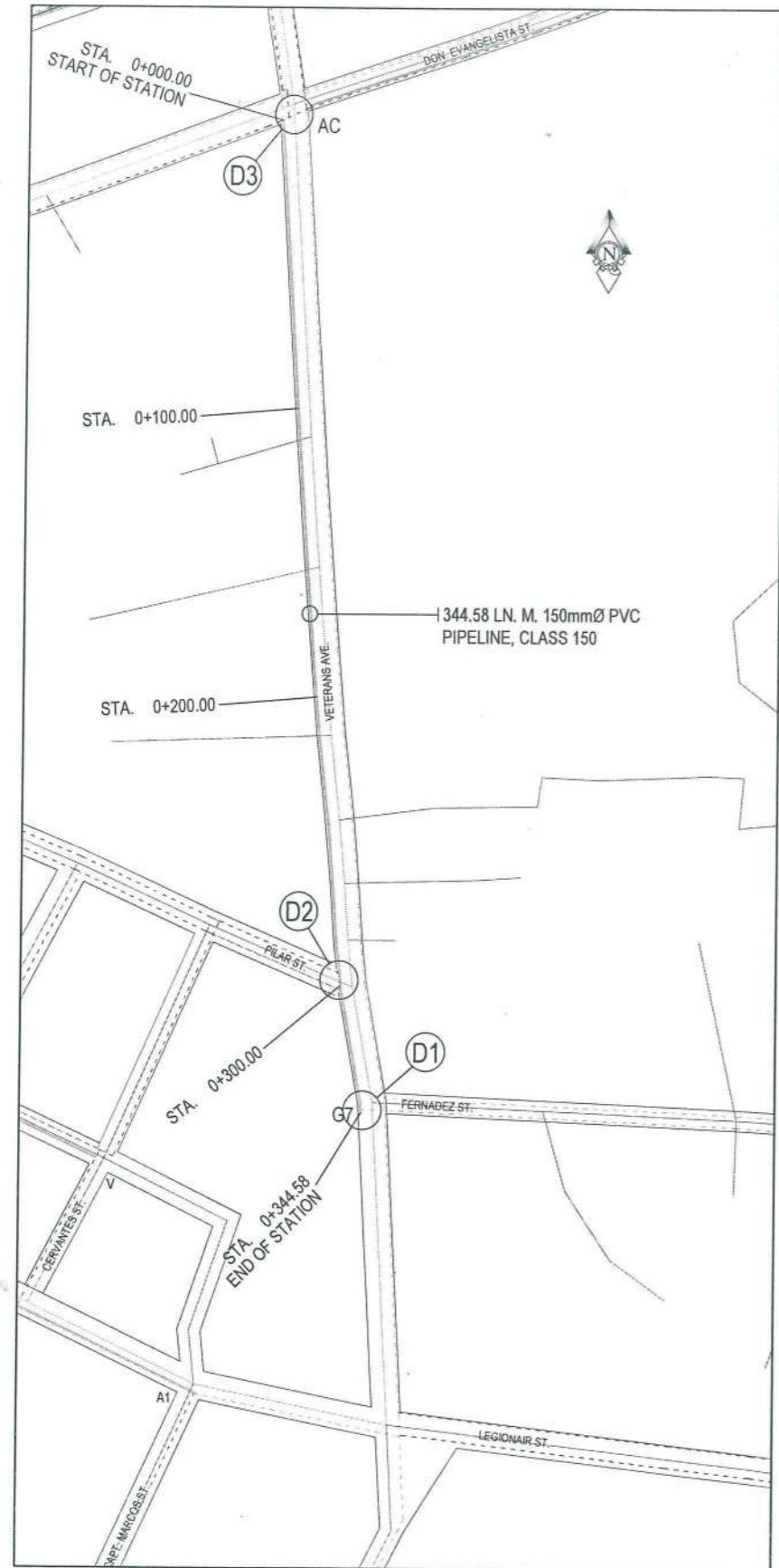

(VETERANS AVE.)  
**SITE DEVELOPMENT PLAN**  
 SCALE: 1:23m

### VETERANS AVE.

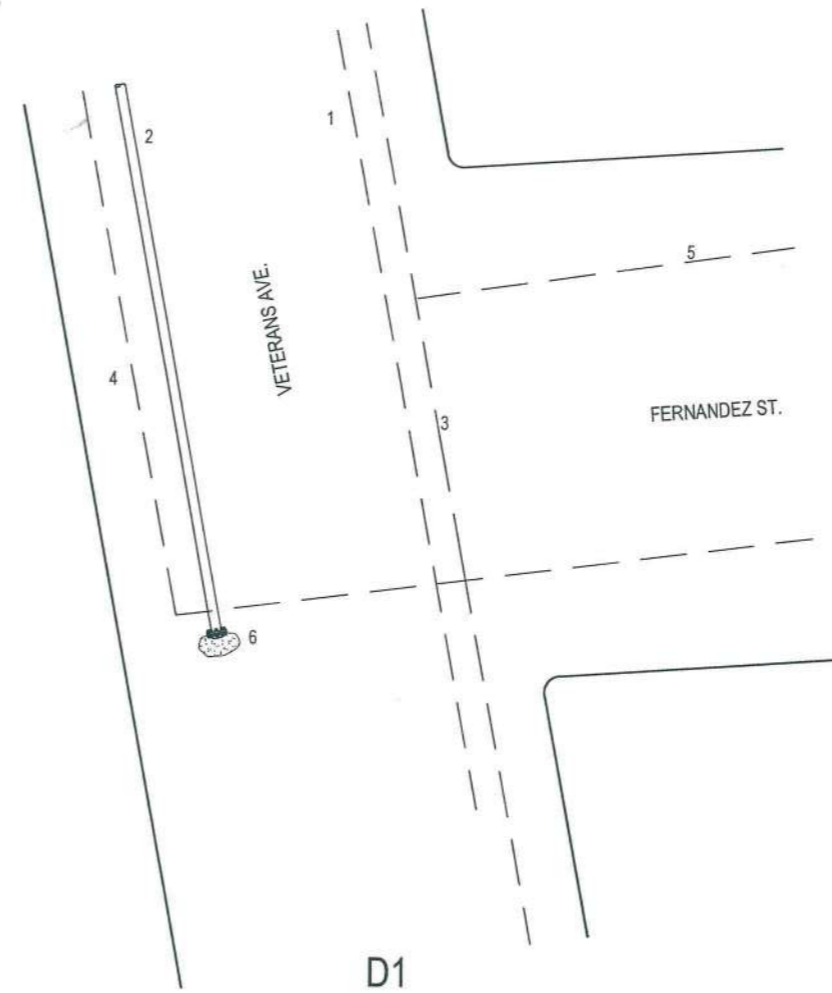

**INTER-CONNECTION DETAIL OF VETERANS AVE.**  
 SCALE: NTS

**LEGEND:**

- 1 - EXIST. 150mmØ PVC PIPELINE, CLASS 150
- 2 - PROP. 344.58 LN. M. 150mmØ PVC PIPELINE, CLASS 150
- 3 - EXISTING 150mmØ CLCI PIPELINE (FOR DECOMMISSION)
- 4 - EXISTING 100mmØ CLCI PIPELINE (FOR DECOMMISSION)
- 5 - EXISTING 150mmØ CLCI PIPELINE
- 6 - EXISTING 150mmØ C.I. MECHANICAL END CAP

	PREPARED BY:  <b>BUNNY L. DAMIGOS</b> SENIOR ENGINEER I, CE DESIGN DIVISION	 <b>LEONARD S. ALCALA, CE</b> ENGINEER II, CEO	 <b>MICHAEL A. FRANCISCO</b> ENGINEER II, CEO OIC, CHIEF PLANNING, DESIGNING AND PROGRAMMING DIVISION, CEO	RECOMMENDING APPROVAL:  <b>MICHAEL C. PALANCA, CE</b> ENGINEER II, CEO OIC, ASSISTANT CITY ENGINEER, CEO	APPROVED FOR PROJECT IMPLEMENTATION:  <b>CHRISTOPHER D. NAVARRO</b> CITY ENGINEER, CEO	PROJECT: <b>MAINLINE REPLACEMENT PROGRAM          (LGU FUNDED) PHASE 2</b>	SHEET NO.: <b>23</b>	
	 <b>VERLIN ANN B. LACASTESANTOS-LORIA</b> SENIOR ENGINEER I, CE DESIGN DIVISION	 <b>REMY D. SALE JR., CE</b> SENIOR ENGINEER I, CE DESIGN DIVISION, ZONED	 <b>ERITO M. BAUTISTA JR., CE</b> OIC, FISCAL OFFICER DESIGN DIVISION, ZONED	 <b>MARLI P. ACOSTA-DE FIESTA</b> OIC, ENGINEERING & CONSTRUCTION DEPARTMENT OIC - TECHNICAL SERVICES GROUP, ZONED	 <b>REYNALDO R. CABILIN</b> ACTING GENERAL MANAGER, ZCWD	SHEET CONTENT: AS INDICATED		



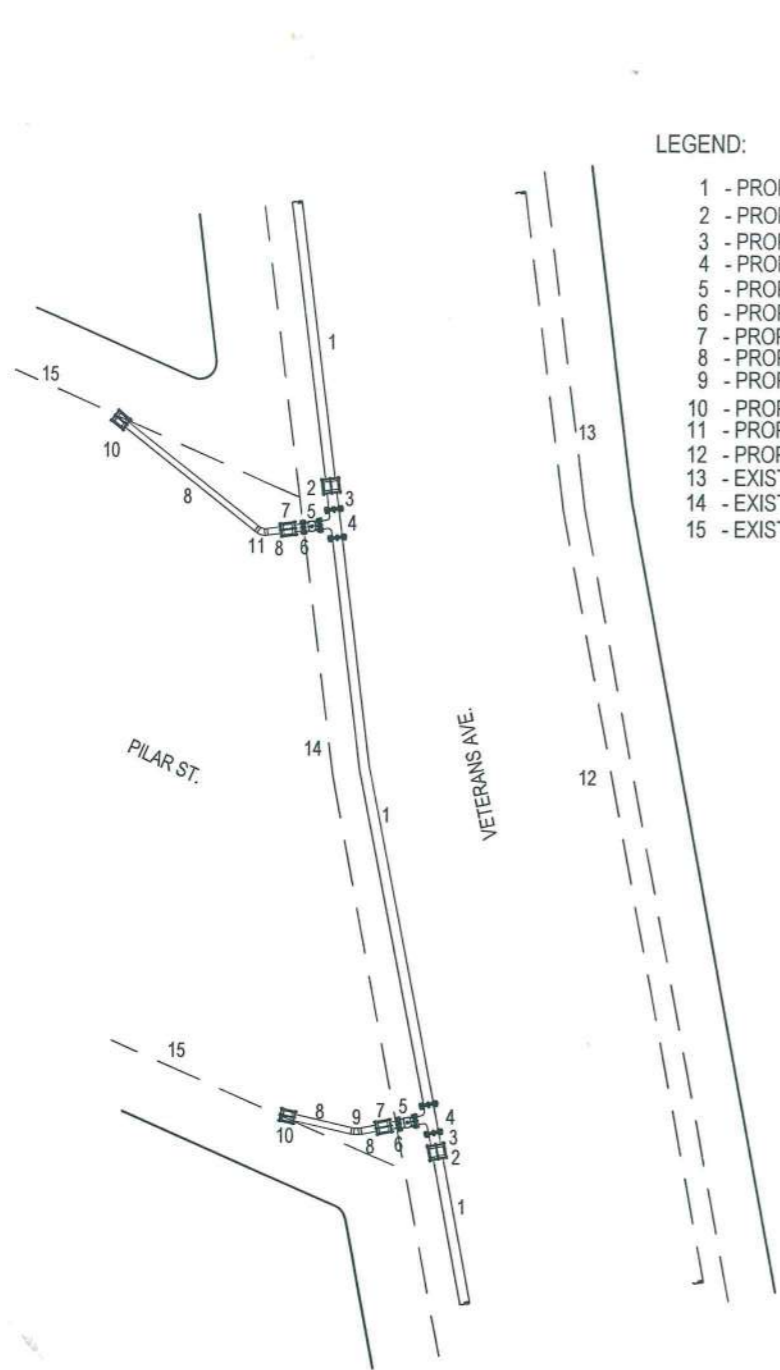

LEGEND:

- 1 - PROP. 344.58 LN. M. 150mmØ PVC PIPELINE, CLASS 150
- 2 - PROP. 150mmØ C.I. SLEEVE TYPE FLEXIBLE COUPLING,(PVC)
- 3 - PROP. 150mmØ PVC SHORT PIPE, CLASS 150
- 4 - PROP. 150mmØ x 100mmØ C.I. TEE, M/F
- 5 - PROP. 100mmØ C.I. BODY GATE VALVE, F/F
- 6 - PROP. 100mmØ C.I. ADAPTOR, F/F
- 7 - PROP. 100mmØ C.I. SLEEVE TYPE FLEXIBLE COUPLING, (C.I.-PVC)
- 8 - PROP. 100mmØ PVC SHORT PIPE, CLASS 150
- 9 - PROP. 100mmØ x 22.5° PVC BEND, CLASS 150
- 10 - PROP. 100mmØ C.I. SLEEVE TYPE FLEXIBLE COUPLING, (PVC)
- 11 - PROP. 100mmØ x 45° PVC BEND, CLASS 150
- 12 - PROP. 150mmØ PVC PIPELINE, CLASS 150
- 13 - EXISTING 150mmØ CLCI PIPELINE (FOR DECOMMISSION)
- 14 - EXISTING 100mmØ CLCI PIPELINE (FOR DECOMMISSION)
- 15 - EXISTING 100mmØ PVC PIPELINE

D2

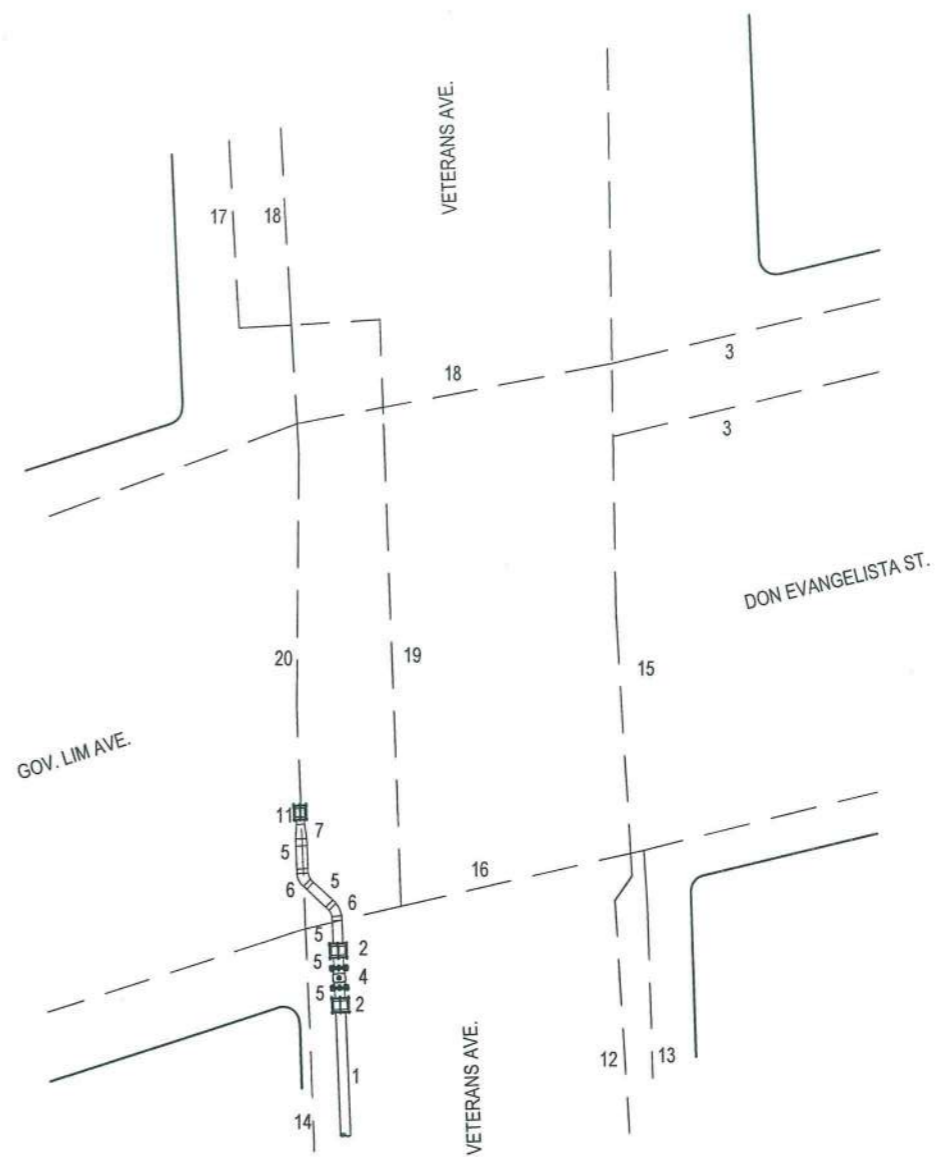

LEGEND:

- 1 - PROP. 344.58 LN. M. 150mmØ PVC PIPELINE, CLASS 150
- 2 - PROP. 150mmØ C.I. SLEEVE TYPE FLEXIBLE COUPLING, (PVC)
- 3 - EXISTING 100mmØ CLCI PIPELINE
- 4 - PROP. 150mmØ C.I. BODY GATE VALVE, M/M
- 5 - PROP. 150mmØ PVC SHORT PIPE, CLASS 150
- 6 - PROP. 150mmØ x 45° PVC BEND, CLASS 150
- 7 - PROP. 150mmØ x 100mmØ PVC REDUCER, CLASS 150
- 8 - PROP. 200mmØ x 150mmØ PVC REDUCER, CLASS 150
- 9 - PROP. 200mmØ PVC SHORT PIPE, CLASS 150
- 10 - PROP. 200mmØ C.I. SLEEVE TYPE FLEXIBLE COUPLING, (C.I.-PVC)
- 11 - PROP. 100mmØ C.I. SLEEVE TYPE FLEXIBLE COUPLING, (C.I.-PVC)
- 12 - PROP. 451.89 LN. M. 150mmØ PVC PIPELINE, CLASS 150
- 13 - EXISTING 150mmØ CLCI PIPELINE (FOR DECOMMISSION)
- 14 - EXISTING 100mmØ CLCI PIPELINE (FOR DECOMMISSION)
- 15 - EXISTING 200mmØ CLCI PIPELINE
- 16 - EXISTING 150mmØ PVC PIPELINE
- 17 - EXISTING 350mmØ CLCS PIPELINE
- 18 - EXISTING 150mmØ CLCI PIPELINE
- 19 - EXISTING 150mmØ CLCS PIPELINE
- 20 - EXISTING 100mmØ CLCI PIPELINE

D3

INTER-CONNECTION DETAIL OF VETERANS AVE.  
SCALE: NTS

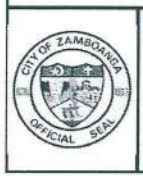

PREPARED BY:

BUNNY L. DAMPIG  
SENIOR ENGINEER, R/CE  
DESIGN DIVISION  
VERLIN ANN B. LACASTESANTOS-LORIA  
SENIOR ENGINEER, R/CE  
DESIGN DIVISION

LEONARDO S. ALCALA, CE  
REGISTERED GEO  
REX D. SALE, JR., CE  
REGISTERED ENGINEER  
DESIGN DIVISION, ZWD

MICHAEL A. FRANCISCO  
REGISTERED GEO  
MICHELLE M. BARTISTA JR., CE  
REGISTERED ENGINEER  
DESIGN DIVISION, ZWD

RECOMMENDING APPROVAL:

MICHAEL O. PALANCA, CE  
REGISTERED ENGINEER  
MICHELLE M. BARTISTA JR., CE  
REGISTERED ENGINEER  
DESIGN DIVISION, ZWD

APPROVED FOR PROJECT IMPLEMENTATION:

CHRISTOPHER O. NAVARRO  
REGISTERED ENGINEER  
REYNALDO R. CABILIN  
ACTING GENERAL MANAGER, ZWD

PROJECT:

MAINLINE REPLACEMENT PROGRAM  
(LGU FUNDED) PHASE 2

SHEET CONTENT:

AS INDICATED

SHEET NO:

24



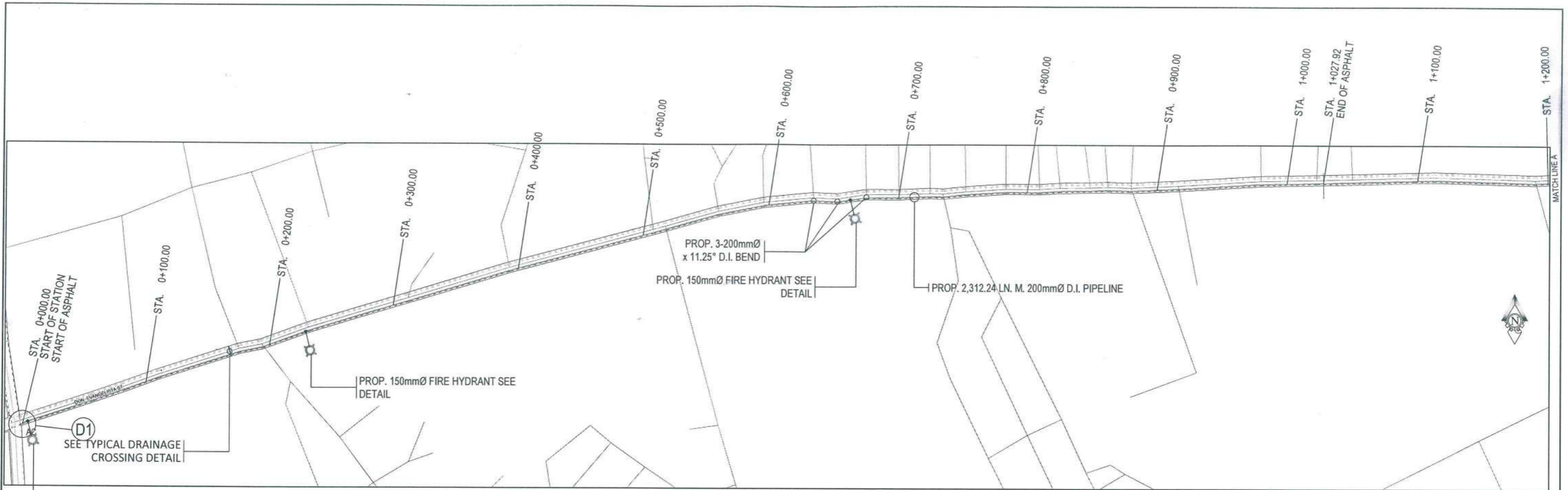

PROP. 150mmØ FIRE HYDRANT SEE DETAIL

SEE TYPICAL DRAINAGE CROSSING DETAIL

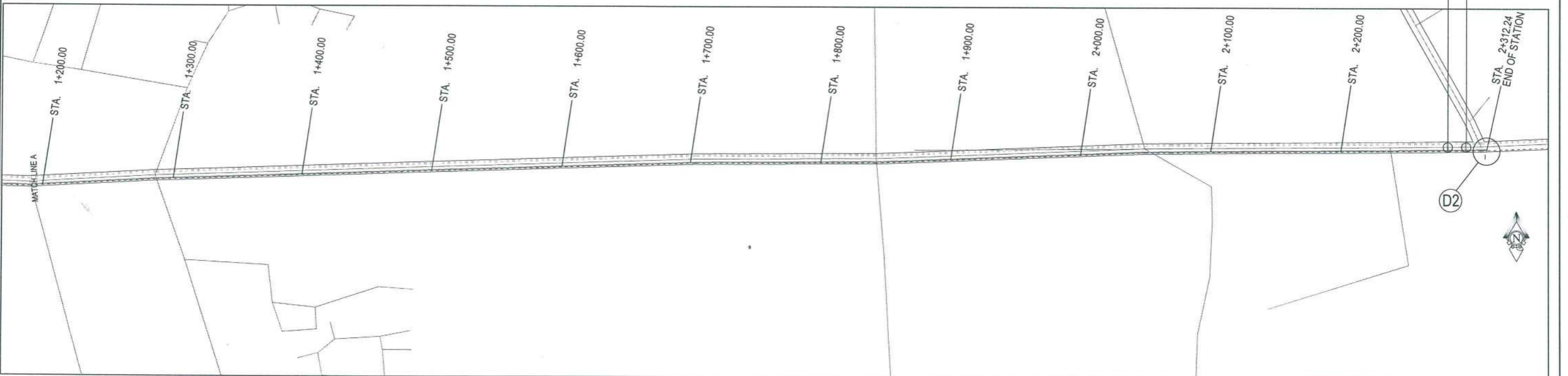

# STA. CATALINA ROAD

## (STA. CATALINA ROAD) SITE DEVELOPMENT PLAN

SCALE: 1:30m

	PREPARED BY:  <b>BUNNY L. DAMPIOS</b> SENIOR ENGINEER A/CE DESIGN DIVISION  <b>VERLIN ANN B. LACASTESANTOS-LORIA</b> SENIOR ENGINEER A/CE DESIGN DIVISION	 <b>LEONARD S. ALCALA, CE</b> ENGINEER II, CEO  <b>REX D. SALE JR., CE</b> SENIOR ENGINEER A DESIGN DIVISION, ZOMB	 <b>MICHAEL A. FRANCISCO</b> ENGINEER II, CEO OIC, CHIEF PLANNING, DESIGNING AND PROGRAMMING DIVISION, CEO  <b>EDITO M. BAUTISTA JR., CE</b> OFFICER IN CHARGE DESIGN DIVISION, ZOMB	RECOMMENDING APPROVAL:  <b>MICHAEL C. PALANCA, CE</b> ENGINEER II OIC ASSISTANT CITY ENGINEER, CEO  <b>MARL P. ACOSTA-DE FIESTA</b> OIC, ENGINEERING & CONSTRUCTION DEPARTMENT OIC, TECHNICAL SERVICES GROUP, ZOMB	APPROVED FOR PROJECT IMPLEMENTATION:  <b>CHRISTOPHER O. NAVARRO</b> CITY ENGINEER, CEO  <b>REYNALDO R. CABILIN</b> ACTING GENERAL MANAGER, ZOMB	PROJECT: <b>MAINLINE REPLACEMENT PROGRAM (LGU FUNDED) PHASE 2</b>	SHEET NO: <b>25</b>	
	SHEET CONTENT: AS INDICATED						SHEET NO: <b>25</b>	