

(P. REYES ST.)
SITE DEVELOPMENT PLAN
 SCALE: 1:8m

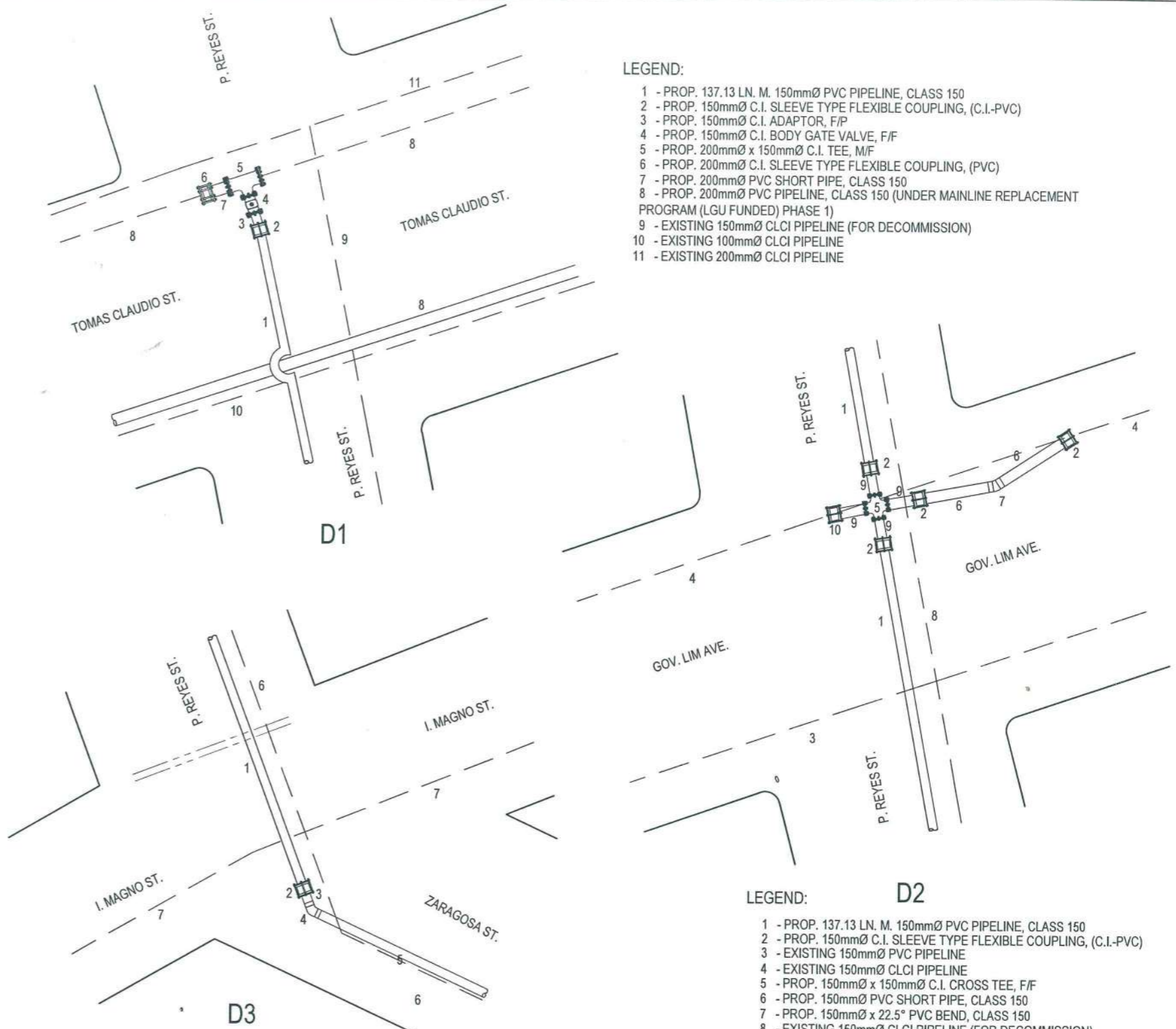

- LEGEND:**
- 1 - PROP. 137.13 LN. M. 150mmØ PVC PIPELINE, CLASS 150
 - 2 - PROP. 150mmØ C.I. SLEEVE TYPE FLEXIBLE COUPLING, (C.I.-PVC)
 - 3 - PROP. 150mmØ C.I. ADAPTOR, F/F
 - 4 - PROP. 150mmØ C.I. BODY GATE VALVE, F/F
 - 5 - PROP. 200mmØ x 150mmØ C.I. TEE, M/F
 - 6 - PROP. 200mmØ C.I. SLEEVE TYPE FLEXIBLE COUPLING, (PVC)
 - 7 - PROP. 200mmØ PVC SHORT PIPE, CLASS 150
 - 8 - PROP. 200mmØ PVC PIPELINE, CLASS 150 (UNDER MAINLINE REPLACEMENT PROGRAM (LGU FUNDED) PHASE 1)
 - 9 - EXISTING 150mmØ CLCI PIPELINE (FOR DECOMMISSION)
 - 10 - EXISTING 100mmØ CLCI PIPELINE
 - 11 - EXISTING 200mmØ CLCI PIPELINE

- LEGEND:**
- 1 - PROP. 137.13 LN. M. 150mmØ PVC PIPELINE, CLASS 150
 - 2 - PROP. 150mmØ C.I. SLEEVE TYPE FLEXIBLE COUPLING, (PVC)
 - 3 - PROP. 150mmØ PVC SHORT PIPE, CLASS 150
 - 4 - PROP. 150mmØ x 45° PVC BEND, CLASS 150
 - 5 - PROP. 150mmØ PVC PIPELINE, CLASS 150 (UNDER ZARAGOSA ST.)
 - 6 - EXISTING 150mmØ CLCI PIPELINE (FOR DECOMMISSION)
 - 7 - EXISTING 100mmØ PVC PIPELINE, CLASS 150

- LEGEND:**
- 1 - PROP. 137.13 LN. M. 150mmØ PVC PIPELINE, CLASS 150
 - 2 - PROP. 150mmØ C.I. SLEEVE TYPE FLEXIBLE COUPLING, (C.I.-PVC)
 - 3 - EXISTING 150mmØ PVC PIPELINE
 - 4 - EXISTING 150mmØ CLCI PIPELINE
 - 5 - PROP. 150mmØ x 150mmØ C.I. CROSS TEE, F/F
 - 6 - PROP. 150mmØ PVC SHORT PIPE, CLASS 150
 - 7 - PROP. 150mmØ x 22.5° PVC BEND, CLASS 150
 - 8 - EXISTING 150mmØ CLCI PIPELINE (FOR DECOMMISSION)
 - 9 - PROP. 150mmØ C.I. ADAPTOR, F/F
 - 10 - PROP. 150mmØ C.I. SLEEVE TYPE FLEXIBLE COUPLING, (C.I.)

P. REYES ST.



PREPARED BY:
BUNNY L. DAMPIOS
 SENIOR ENGINEER & CE
 DESIGN DIVISION
VERLIN ANN B. LACASTESANTOS-LORIA
 SENIOR ENGINEER & CE
 DESIGN DIVISION

LEONARDO S. ALCALA, CE
 ENGINEER II, CE
 DESIGN DIVISION
REX D. SALE JR., CE
 SENIOR ENGINEER & CE
 DESIGN DIVISION, ZOND

RECOMMENDING APPROVAL:
MICHAEL A. FRANCISCO
 SENIOR ENGINEER II, CE
 OIC, CHIEF PLANNING, DESIGN AND PROGRAMMING DIVISION, CE
EDITO M. BAUTISTA JR., CE
 OFFICER IN CHARGE
 DESIGN DIVISION, ZOND

APPROVED FOR PROJECT IMPLEMENTATION:
MICHAEL G. PALANCA, CE
 ENGINEER II
 OIC ASSISTANT IN CHARGE, CE
MARILYN P. ACOSTA-DE FIESTA
 OMA, ENGINEERING & CONSTRUCTION DEPARTMENT
 OIC TECHNICAL SERVICES GROUP, ZOND

PROJECT:
MAINLINE REPLACEMENT PROGRAM (LGU FUNDED) PHASE 2

SHEET CONTENT:
 AS INDICATED

SHEET NO:
13

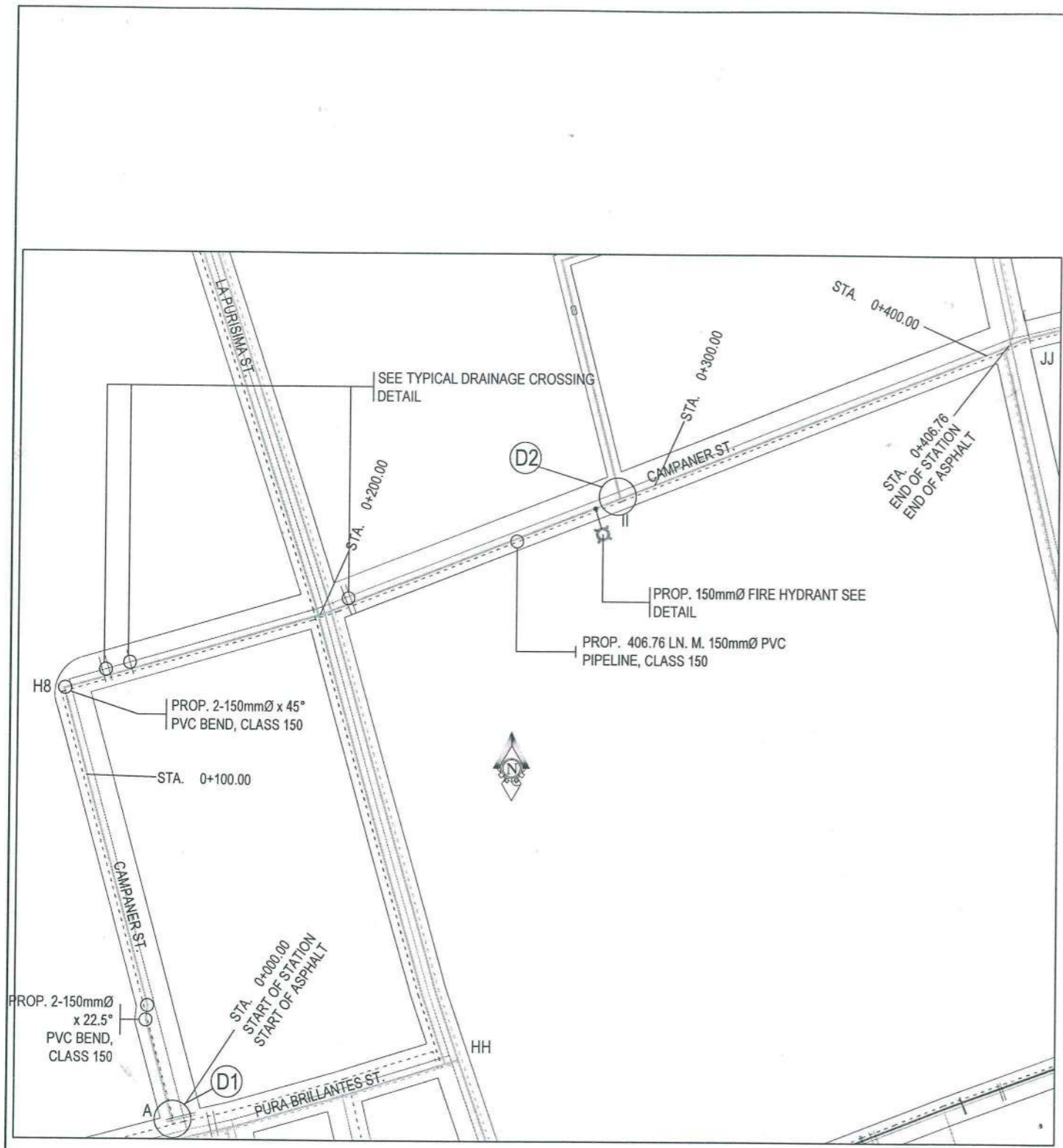

(CAMPANER ST.)
SITE DEVELOPMENT PLAN
 SCALE: 1:15m

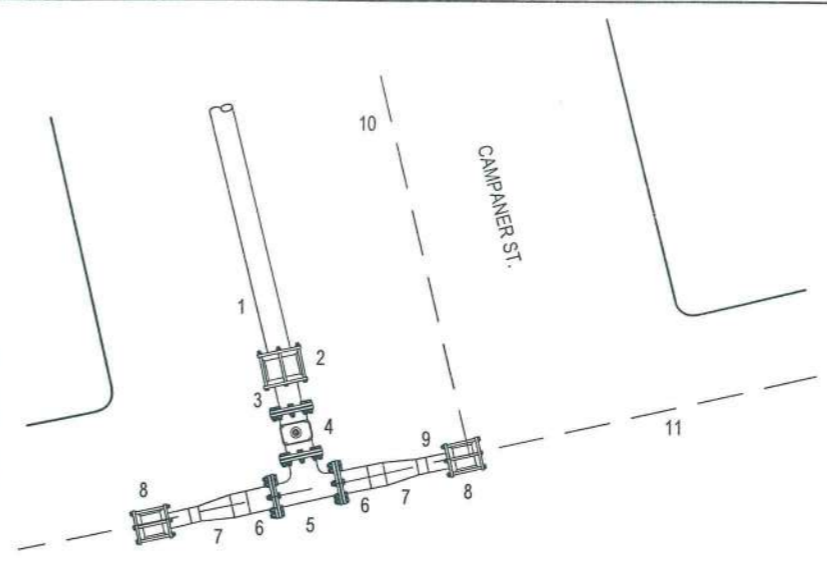

- LEGEND:**
- 1 - PROP. 406.76 LN. M. 150mmØ PVC PIPELINE, CLASS 150
 - 2 - PROP. 150mmØ C.I. SLEEVE TYPE FLEXIBLE COUPLING, (C.I.-PVC)
 - 3 - PROP. 150mmØ C.I. ADAPTOR, F/P
 - 4 - PROP. 150mmØ C.I. BODY GATE VALVE, F/F
 - 5 - PROP. 150mmØ x 150mmØ C.I. TEE, M/F
 - 6 - PROP. 150mmØ PVC SHORT PIPE, CLASS 150
 - 7 - PROP. 150mmØ x 100mmØ PVC REDUCER, CLASS 150
 - 8 - PROP. 100mmØ C.I. SLEEVE TYPE FLEXIBLE COUPLING, (PVC)
 - 9 - PROP. 100mmØ PVC SHORT PIPE, CLASS 150
 - 10 - EXISTING 100mmØ PVC PIPELINE (FOR DECOMMISSION)
 - 11 - EXISTING 100mmØ PVC PIPELINE
 - 12 - EXISTING 100mmØ PVC PIPELINE
 - 13 - EXISTING 100mmØ C.I. PIPELINE

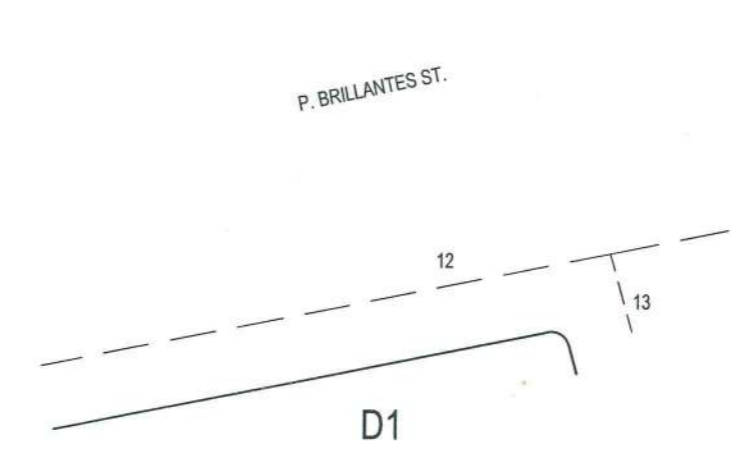

- LEGEND:**
- 1 - PROP. 406.76 LN. M. 150mmØ PVC PIPELINE, CLASS 150
 - 2 - PROP. 150mmØ C.I. SLEEVE TYPE FLEXIBLE COUPLING, (C.I.-PVC)
 - 3 - PROP. 150mmØ C.I. ADAPTOR, F/P
 - 4 - PROP. 150mmØ C.I. BODY GATE VALVE, F/F
 - 5 - PROP. 150mmØ x 150mmØ C.I. TEE, M/F
 - 6 - PROP. 150mmØ PVC PIPELINE, CLASS 150 (UNDER GONZALES DRIVE)
 - 7 - EXISTING 100mmØ PVC PIPELINE, CLASS 150 (FOR DECOMMISSION)
 - 8 - EXISTING 50mmØ PB PIPELINE
 - 9 - PROP. 150mmØ C.I. SLEEVE TYPE FLEXIBLE COUPLING, (PVC)
 - 10 - PROP. 150mmØ PVC SHORT PIPE, CLASS 150

CAMPANER ST.

INTER-CONNECTION DETAIL

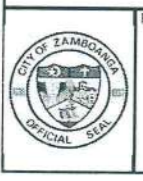

PREPARED BY:
BUNNY L. DAMPIOS
 SENIOR ENGINEER & ICE
 DESIGN DIVISION
VERLIN ANN B. LACASTESANTOS-LORIA
 SENIOR ENGINEER & ICE
 DESIGN DIVISION

[Signature]
LEONARDO S. ALCALA, CE
 ENGINEER II, GEO
REX D. SALE JR., CE
 JUNIOR ENGINEER
 DESIGN DIVISION, ZONE

[Signature]
MICHAEL A. FRANCISCO
 ENGINEER II, CE
 OIC, CHIEF PLANNING, DESIGNING & PROGRAMMING DIVISION, CEO
EDITO M. BAUTISTA JR., CE
 OFFICER IN CHARGE
 DESIGN DIVISION, ZONE

RECOMMENDING APPROVAL:
[Signature]
MICHAEL C. PALANCA, CE
 ENGINEER II, CE
 OIC, ASSISTANT CITY ENGINEER, CEO
MARI P. ACOSTA-DE FIESTA
 OIC, CHIEF ENGINEERING & CONSTRUCTION DEPARTMENT
 OIC, TECHNICAL SERVICES GROUP, ZONE

APPROVED FOR PROJECT IMPLEMENTATION:
[Signature]
CHRISTOPHER Q. NAVARRO
 CITY ENGINEER, CEO
REYNALDO R. CABILIN
 ACTING GENERAL MANAGER, ZONE

PROJECT: **MAINLINE REPLACEMENT PROGRAM (LGU FUNDED) PHASE 2**
 SHEET CONTENT: **AS INDICATED**

SHEET NO: **14**



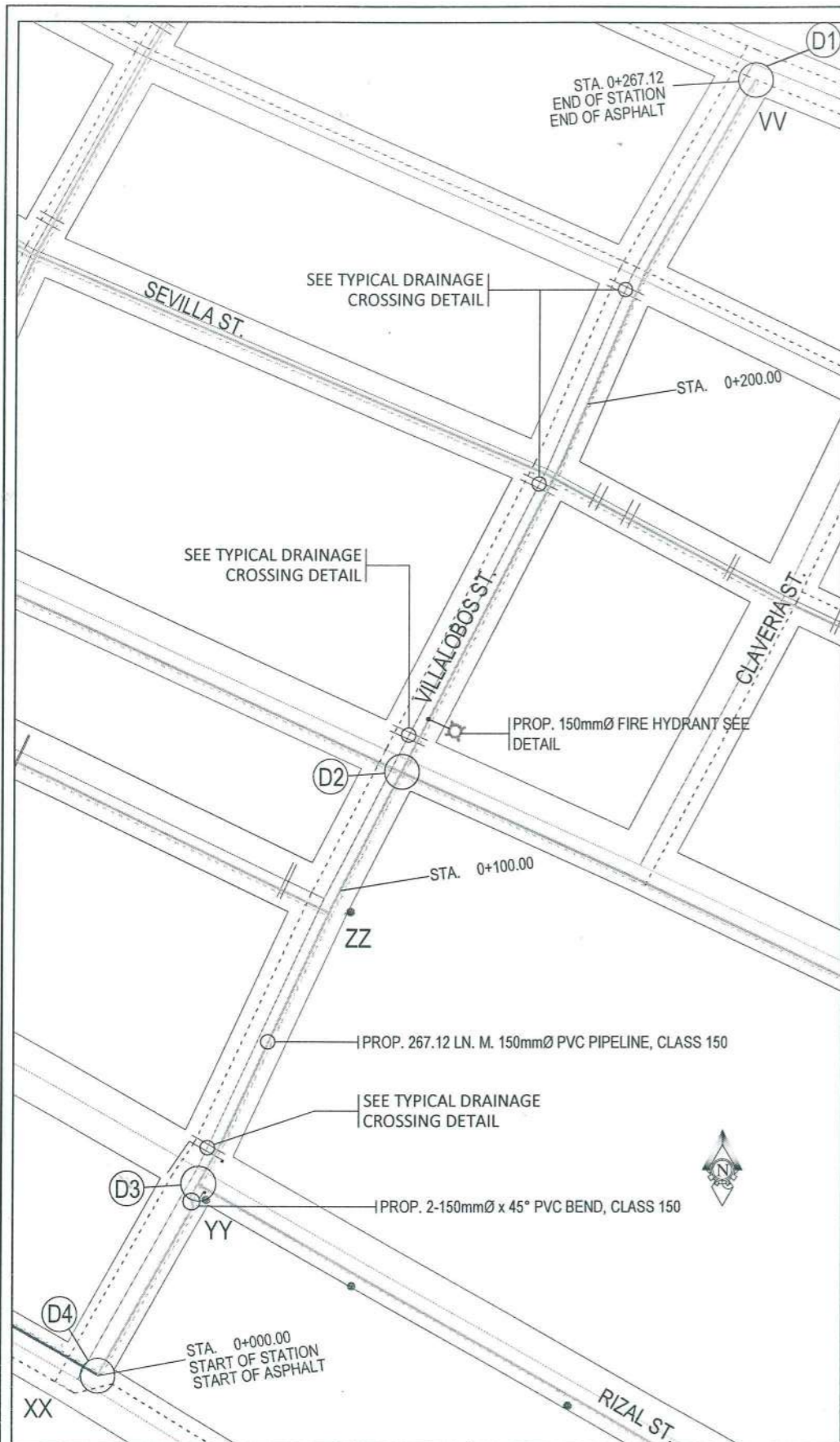

(VILLALOBOS ST.)
SITE DEVELOPMENT PLAN
 SCALE: 1:11m

VILLALOBOS ST.

INTER-CONNECTION DETAIL OF VILLALOBOS ST.
 SCALE: NTS



LEGEND:

- 1 - PROP. 267.12 LN. M. 150mmØ PVC PIPELINE, CLASS 150
- 2 - PROP. 150mmØ C.I. SLEEVE TYPE FLEXIBLE COUPLING, (C.I.-PVC)
- 3 - PROP. 150mmØ C.I. ADAPTOR, F/F
- 4 - PROP. 150mmØ C.I. BODY GATE VALVE, F/F
- 5 - EXISTING 100mmØ PVC PIPELINE
- 6 - PROP. 150mmØ x 150mmØ C.I. TEE, M/F
- 7 - PROP. 150mmØ PVC SHORT PIPE, CLASS 150
- 8 - PROP. 150mmØ x 100mmØ PVC REDUCER, CLASS 150
- 9 - PROP. 100mmØ C.I. SLEEVE TYPE FLEXIBLE COUPLING, (PVC)
- 10 - EXISTING 100mmØ CLCI PIPELINE (FOR DECOMMISSION)

LEGEND:

- 1 - PROP. 267.12 LN. M. 150mmØ PVC PIPELINE, CLASS 150
- 2 - PROP. 150mmØ C.I. ADAPTOR, F/F
- 3 - PROP. 150mmØ x 100mmØ C.I. REDUCER, F/F
- 4 - PROP. 150mmØ C.I. SLEEVE TYPE FLEXIBLE COUPLING, (C.I.-PVC)
- 5 - PROP. 150mmØ x 150mmØ C.I. CROSS TEE, F/F
- 6 - EXISTING 100mmØ PVC PIPELINE
- 7 - PROP. 100mmØ C.I. ADAPTOR, F/F
- 8 - PROP. 100mmØ C.I. SLEEVE TYPE FLEXIBLE COUPLING, (C.I.-PVC)
- 9 - PROP. 150mmØ PVC PIPELINE, CLASS 150 (UNDER GEN. VICENTE ALVAREZ ST.)
- 10 - EXISTING 150mmØ CLCI PIPELINE (FOR DECOMMISSION)
- 11 - EXISTING 100mmØ CLCI PIPELINE



PREPARED BY:

BUNNY L. DAMPIOS
 SENIOR ENGINEER & CE
 DESIGN DIVISION
 VERLIN ANN B. LACASTESANTOS-LORIA
 SENIOR ENGINEER & CE
 DESIGN DIVISION

LEONARDO S. ALCALA, CE
 ENGINEER II, CEO
 REYNOLDO R. CABILAN
 SENIOR ENGINEER & CE
 DESIGN DIVISION, ZOWG

MICHAEL A. FRANCISCO
 ENGINEER II, CEO
 OIC, CHIEF PLANNING, DESIGNING AND PROGRAMMING DIVISION, CEO
 EDITO M. BAUTISTA, JR., CE
 SENIOR ENGINEER & CE
 DESIGN DIVISION, ZOWG

RECOMMENDING APPROVAL:
 MICHAEL C. PALANCA, CE
 ENGINEER II
 OIC, ASSISTANT CITY ENGINEER, CEO
 MARLI P. ACOSTA-DE FIESTA
 OIC, ENGINEERING & CONSTRUCTION DEPARTMENT
 OIC, TECHNICAL SERVICES GROUP, ZOWG

APPROVED FOR PROJECT IMPLEMENTATION:
 CHRISTOPHER O. NAVARRO
 CITY ENGINEER
 REYNALDO R. CABILAN
 ACTING GENERAL MANAGER, ZOWG

PROJECT:
 MAINLINE REPLACEMENT PROGRAM
 (LGU FUNDED) PHASE 2
 SHEET CONTENT:
 AS INDICATED

SHEET NO.
 15

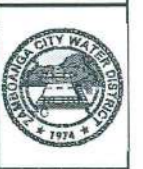

LEGEND:

- 1 - PROP. 267.12 LN. M. 150mmØ PVC PIPELINE, CLASS 150
- 2 - PROP. 150mmØ C.I. SLEEVE TYPE FLEXIBLE COUPLING, (C.I.-PVC)
- 3 - PROP. 150mmØ C.I. ADAPTOR, F/P
- 4 - PROP. 150mmØ x 150mmØ C.I. TEE, F/F
- 5 - PROP. 150mmØ C.I. BODY GATE VALVE, F/F
- 6 - PROP. 150mmØ PVC PIPELINE, CLASS 150 (UNDER RIZAL ST.)
- 7 - EXISTING 100mmØ CLCI PIPELINE (FOR DECOMMISSION)
- 8 - EXISTING 150mmØ CLCI PIPELINE
- 9 - EXISTING 100mmØ PVC PIPELINE

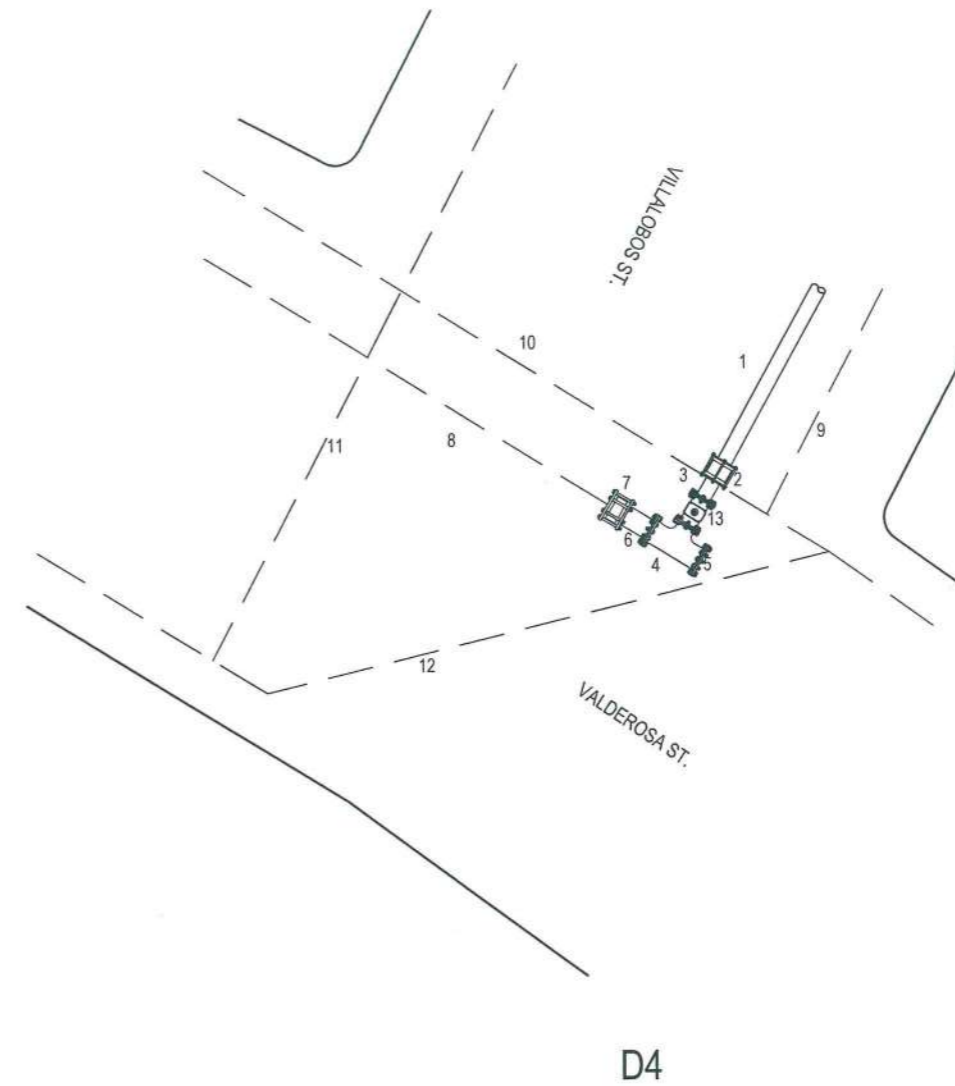

LEGEND:

- 1 - PROP. 267.12 LN. M. 150mmØ PVC PIPELINE, CLASS 150
- 2 - PROP. 150mmØ C.I. SLEEVE TYPE FLEXIBLE COUPLING, (C.I.-PVC)
- 3 - PROP. 150mmØ C.I. ADAPTOR, F/P
- 4 - PROP. 200mmØ x 150mmØ C.I. TEE, F/F
- 5 - PROP. 200mmØ MS BLIND FLANGE
- 6 - PROP. 200mmØ C.I. ADAPTOR, F/P
- 7 - PROP. 200mmØ C.I. SLEEVE TYPE FLEXIBLE COUPLING, (C.I.-PVC)
- 8 - PROP. 200mmØ PVC PIPELINE, CLASS 150 (UNDER MAINLINE REPLACEMENT PROGRAM (LGU FUNDED) PHASE 1)
- 9 - EXISTING 100mmØ CLCI PIPELINE (FOR DECOMMISSION)
- 10 - EXISTING 200mmØ CLCI PIPELINE
- 11 - EXISTING 100mmØ PVC PIPELINE
- 12 - EXISTING 150mmØ PVC PIPELINE
- 13 - PROP. 150mmØ C.I. BODY GATE VALVE, F/F

INTER-CONNECTION DETAIL OF VILLALOBOS ST.

SCALE: NTS

	PREPARED BY:  BUNNY L. DAMPIGS SENIOR ENGINEER A, CE DESIGN DIVISION	 LEONARD S. ALCALA, CE ENGINEER II, CEO	 MICHAEL A. FRANCISCO DIVISION CHIEF II, CEO DIVISION CHIEF PLANNING, DESIGNING AND PROGRAMMING DIVISION, CEO	 MICHAEL C. PALANCA, CE ENGINEER II DIVISION CHIEF ASSISTANT, DIVISION CHIEF DIVISION CHIEF PLANNING, DESIGNING AND PROGRAMMING DIVISION, CEO	 CHRISTOPHER D. NAVARRO CITY ENGINEER II	PROJECT: MAINLINE REPLACEMENT PROGRAM (LGU FUNDED) PHASE 2	SHEET NO.: 16	
	PREPARED BY:  VERLIN ANN B. LACASTESANTOS-LORIA SENIOR ENGINEER F, CE DESIGN DIVISION	 REX D. GALE, JR., CE DIVISION CHIEF ENGINEER A DESIGN DIVISION, ZCWD	 EDITO M. BAUTISTA JR., CE OFFICER IN CHARGE DESIGN DIVISION, ZCWD	 MARIA P. ACOSTA-DE FIESTA DIVISION CHIEF ASSISTANT DIVISION CHIEF PLANNING, DESIGNING AND PROGRAMMING DIVISION, CEO	 REYNALDO R. CABALIN ACTING GENERAL MANAGER, ZCWD	APPROVED FOR PROJECT IMPLEMENTATION: SHEET CONTENT: AS INDICATED	SHEET NO.: 16	

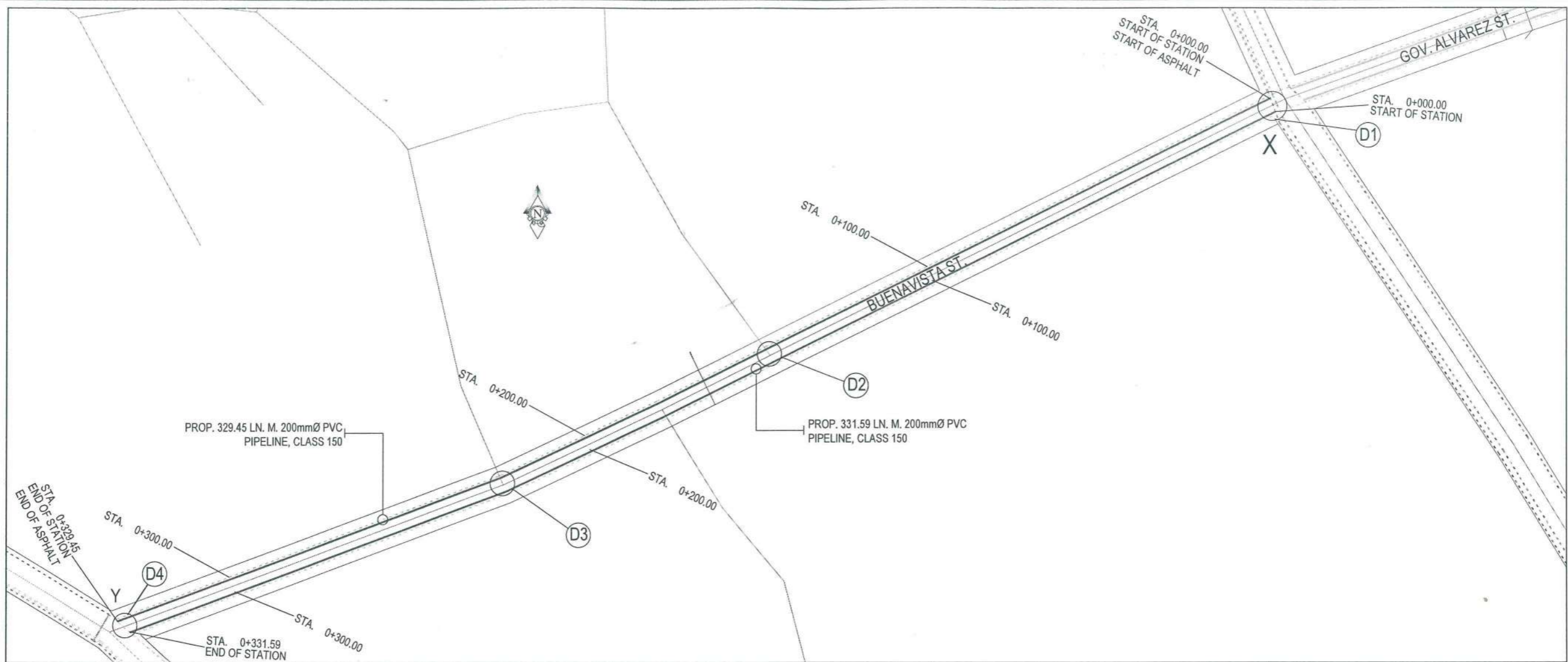

(BUENVISTA ST.)
SITE DEVELOPMENT PLAN
SCALE: 1:11m

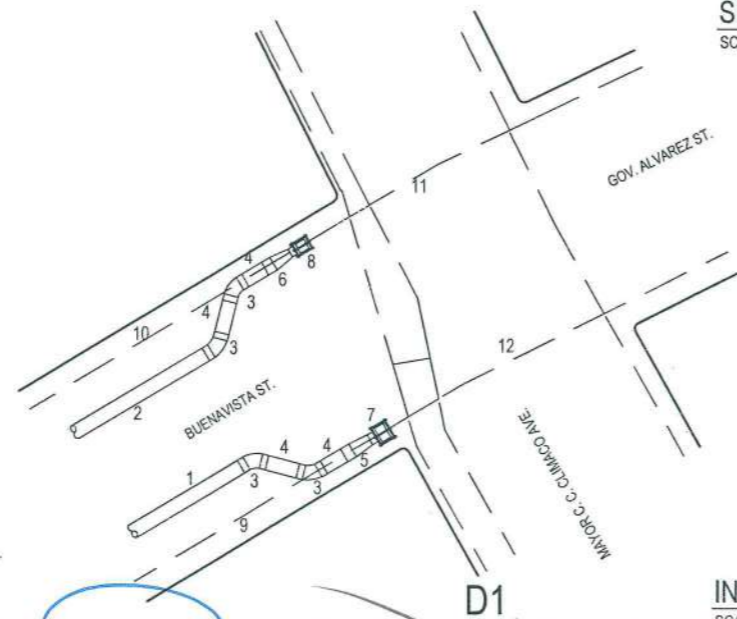

- LEGEND:**
- 1 - PROP. 329.45 LN. M. 200mmØ PVC PIPELINE, CLASS 150
 - 2 - PROP. 331.59 LN. M. 200mmØ PVC PIPELINE, CLASS 150
 - 3 - PROP. 200mmØ x 45° PVC BEND, CLASS 150
 - 4 - PROP. 200mmØ PVC SHORT PIPE, CLASS 150
 - 5 - PROP. 200mmØ x 150mmØ PVC REDUCER, CLASS 150
 - 6 - PROP. 200mmØ x 100mmØ PVC REDUCER, CLASS 150
 - 7 - PROP. 150mmØ C.I. SLEEVE TYPE FLEXIBLE COUPLING, (C.I.-PVC)
 - 8 - PROP. 100mmØ C.I. SLEEVE TYPE FLEXIBLE COUPLING, (C.I.-PVC)
 - 9 - EXISTING 150mmØ CLCI PIPELINE (FOR DECOMMISSION)
 - 10 - EXISTING 100mmØ CLCI PIPELINE (FOR DECOMMISSION)
 - 11 - EXISTING 100mmØ PVC SHORT PIPE, CLASS 150
 - 12 - EXISTING 150mmØ PVC SHORT PIPE, CLASS 150

BUENVISTA ST.

INTER-CONNECTION DETAIL
SCALE: NTS

	PREPARED BY: BUNNY L. DAMPIOS SENIOR ENGINEER II, C.E. DESIGN DIVISION	 LEONARD S. ALCALA, CE ENGINEER II, C.E.	 MICHAEL A. FRANCISCO ENGINEER II, C.E. OIC, CHIEF PLANNING, DESIGNING AND PROGRAMMING DIVISION, ZOWD	RECOMMENDING APPROVAL: MICHAEL C. PALANCA, CE ENGINEER II OIC-ASSISTANT OF ENGINEER, C.E.	APPROVED FOR PROJECT IMPLEMENTATION: CHRISTOPHER S. NAVARRO CITY ENGINEER	PROJECT: MAINLINE REPLACEMENT PROGRAM (LGU FUNDED) PHASE 2	SHEET NO.: 17
	 VERLIN ANN B. LACASTESANTOS-LORIA SENIOR ENGINEER I, C.E. DESIGN DIVISION	 REX D. SALE, JR., CE PROFESSIONAL ENGINEER DESIGN DIVISION, ZOWD	 EDIFO M. BAUTISTA, JR., CE PROFESSIONAL ENGINEER DESIGN DIVISION, ZOWD	 MARLI P. ACOSTA-DE FIESTA DVA, ENGINEERING & CONSTRUCTION DEPARTMENT OIC - TECHNICAL SERVICES GROUP, ZOWD	 REYNALDO Y. CABALIN ACTING GENERAL MANAGER, ZOWD	SHEET CONTENT: AS INDICATED	

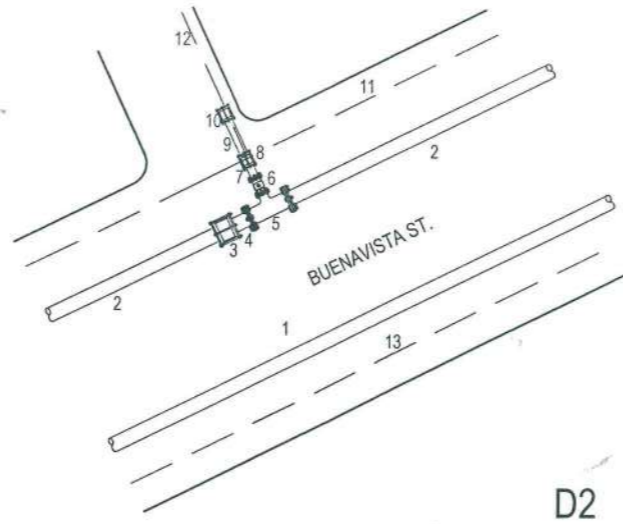

LEGEND:

- 1 - PROP. 329.45 LN. M. 200mmØ PVC PIPELINE, CLASS 150
- 2 - PROP. 331.59 LN. M. 200mmØ PVC PIPELINE, CLASS 150
- 3 - PROP. 200mmØ C.I. SLEEVE TYPE FLEXIBLE COUPLING, (PVC)
- 4 - PROP. 200mmØ PVC SHORT PIPE, CLASS 150
- 5 - PROP. 200mmØ x 100mmØ C.I. TEE, M/F
- 6 - PROP. 100mmØ C.I. BODY GATE VALVE, F/F
- 7 - PROP. 100mmØ C.I. ADAPTOR, F/P
- 8 - PROP. 100mmØ C.I. SLEEVE TYPE FLEXIBLE COUPLING, (C.I.-PVC)
- 9 - PROP. 100mmØ PVC SHORT PIPE, CLASS 150
- 10 - PROP. 100mmØ C.I. SLEEVE TYPE FLEXIBLE COUPLING, (PVC)
- 11 - EXISTING 100mmØ CLCI PIPELINE (FOR DECOMMISSION)
- 12 - EXISTING 100mmØ PVC PIPELINE
- 13 - EXISTING 150mmØ CLCI PIPELINE (FOR DECOMMISSION)

D2

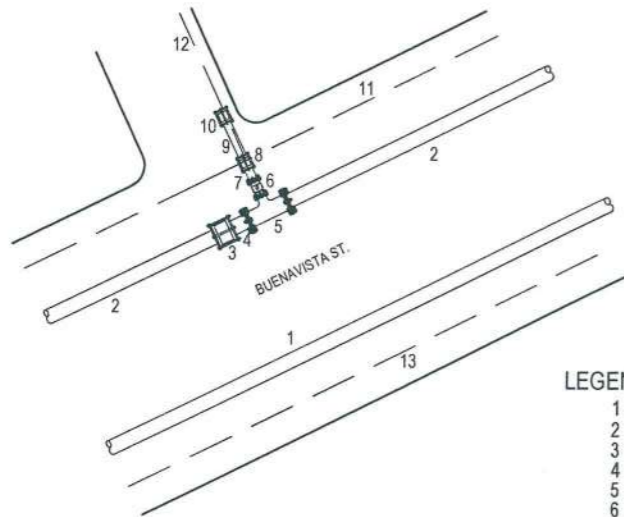

LEGEND:

- 1 - PROP. 329.45 LN. M. 200mmØ PVC PIPELINE, CLASS 150
- 2 - PROP. 331.59 LN. M. 200mmØ PVC PIPELINE, CLASS 150
- 3 - PROP. 200mmØ C.I. SLEEVE TYPE FLEXIBLE COUPLING, (PVC)
- 4 - PROP. 200mmØ PVC SHORT PIPE, CLASS 150
- 5 - PROP. 200mmØ x 100mmØ C.I. TEE, M/F
- 6 - PROP. 100mmØ C.I. BODY GATE VALVE, F/F
- 7 - PROP. 100mmØ C.I. ADAPTOR, F/P
- 8 - PROP. 100mmØ C.I. SLEEVE TYPE FLEXIBLE COUPLING, (C.I.-PVC)
- 9 - PROP. 100mmØ PVC SHORT PIPE, CLASS 150
- 10 - PROP. 100mmØ C.I. SLEEVE TYPE FLEXIBLE COUPLING, (PVC)
- 11 - EXISTING 100mmØ CLCI PIPELINE (FOR DECOMMISSION)
- 12 - EXISTING 100mmØ PVC PIPELINE
- 13 - EXISTING 150mmØ CLCI PIPELINE (FOR DECOMMISSION)

D3

LEGEND:

- 1 - PROP. 329.45 LN. M. 200mmØ PVC PIPELINE, CLASS 150
- 2 - PROP. 331.59 LN. M. 200mmØ PVC PIPELINE, CLASS 150
- 3 - PROP. 200mmØ x 22.5° PVC BEND, CLASS 150
- 4 - PROP. 200mmØ PVC SHORT PIPE, CLASS 150
- 5 - PROP. 200mmØ C.I. SLEEVE TYPE FLEXIBLE COUPLING, (C.I.-PVC)
- 6 - PROP. 200mmØ C.I. ADAPTOR, F/P
- 7 - PROP. 200mmØ C.I. BODY GATE VALVE, F/F
- 8 - PROP. 200mmØ x 200mmØ C.I. TEE, M/F
- 9 - EXISTING 200mmØ PVC PIPELINE
- 10 - EXISTING 200mmØ CLCI PIPELINE
- 11 - PROP. 200mmØ x 150mmØ PVC REDUCER, CLASS 150
- 12 - PROP. 150mmØ C.I. SLEEVE TYPE FLEXIBLE COUPLING, (C.I.-PVC)
- 13 - EXISTING 150mmØ CLCI PIPELINE (FOR DECOMMISSION)
- 14 - EXISTING 100mmØ CLCI PIPELINE (FOR DECOMMISSION)
- 15 - EXISTING 150mmØ CLCI PIPELINE
- 16 - EXISTING 150mmØ PVC PIPELINE

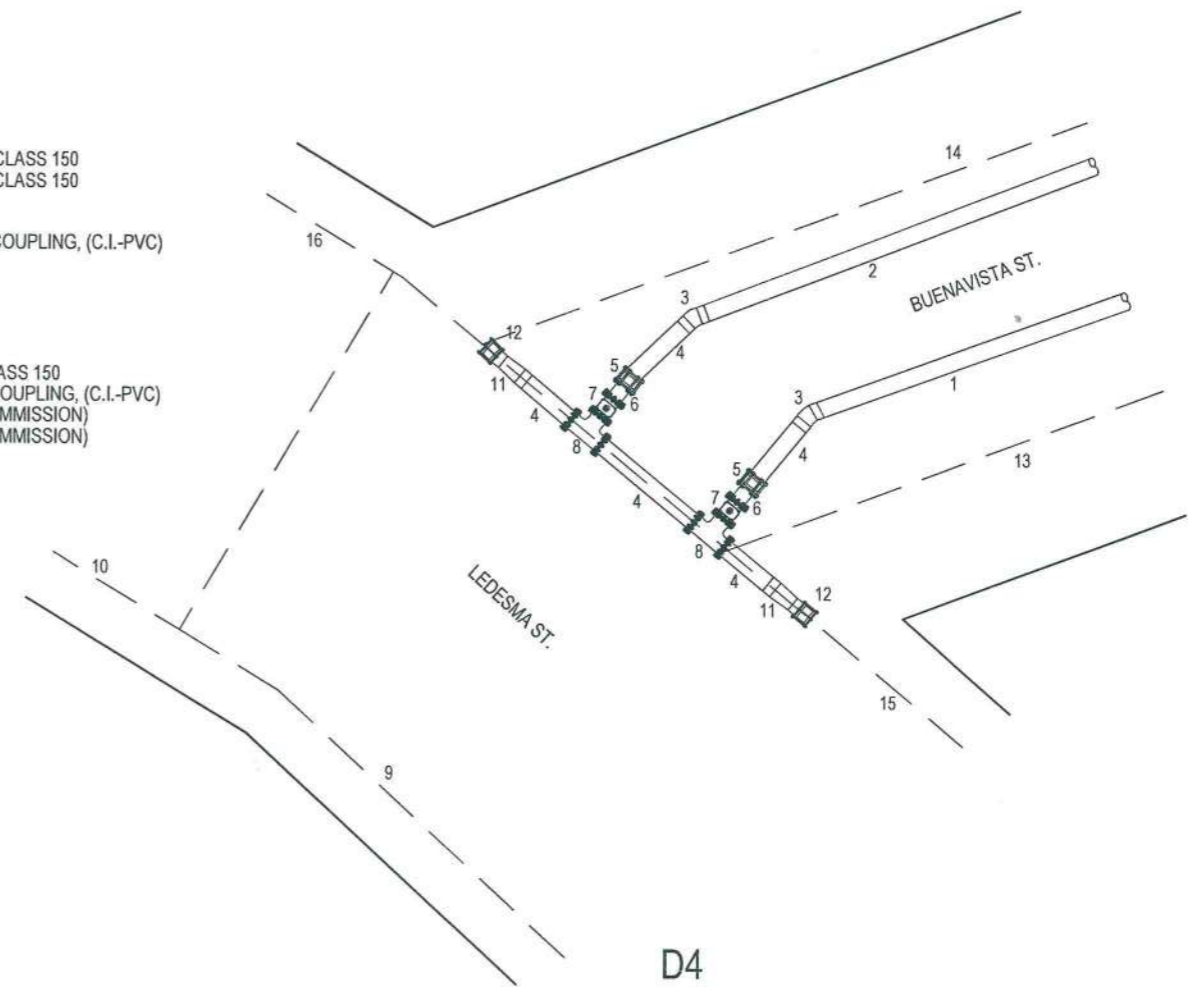

D4

INTER-CONNECTION DETAIL OF BUENVISTA ST.

SCALE: NTS



PREPARED BY:

BUNNY L. DAMPIOS
SENIOR ENGINEER & CE
DESIGN DIVISION
VERLIN ANN B. LACASTESANTOS-LORIA
SENIOR ENGINEER & SA
DESIGN DIVISION

LEONARD S. ALCALA, CE
ENGINEER & CE
REY D. SALE JR., CE
REGISTERED ENGINEER & SA
DESIGN DIVISION, ZCWD

MICHAEL A. FRANCISCO
ENGINEER & CE
D/C, CHIEF PLANNING, DESIGNING AND PROGRAMMING DIVISION, ZCWD
EDWIN M. BAUTISTA JR., CE
OFFICER-IN-CHARGE
DESIGN DIVISION, ZCWD

RECOMMENDING APPROVAL:

MICHAEL C. PALANCA, CE
ENGINEER & CE
D/ASSISTANT CITY ENGINEER, ZCWD
MARLUP ACOSTA-DE FIESTA
DM & ENGINEERING & CONSTRUCTION DEPARTMENT
D/C, TECHNICAL SERVICES GROUP, ZCWD

APPROVED FOR PROJECT IMPLEMENTATION:

CHRISTOPHER D. NAWARRO
CITY ENGINEER, ZCWD
REYNALDO R. CABILIN
ACTING GENERAL MANAGER, ZCWD

PROJECT:

MAINLINE REPLACEMENT PROGRAM
(LGU FUNDED) PHASE 2

SHEET CONTENT:

AS INDICATED

SHEET NO.:

18

